



rp   
**technik**



a company of the welsper profile group



Supreme functionality

# RP Technik

Profile systems and standard profiles

Phone: (08) 9399 6957  
Address: 17 Williams Road Kelmscott WA 6111  
Email: Sales@AustralianFireControl.com.au  
Postal: PO BOX 1008 DC Kelmscott WA 6997  
[www.australianFireControl.com.au](http://www.australianFireControl.com.au)

## The right system solution for every application

**Established in the marketplace since 1906, RP Technik has developed from a successful manufacturer of standard profiles into an international provider of systems for curtain walls, windows, doors and partition walls in steel and stainless steel.**

The steel profiles from RP Technik's early years are now true classics, in daily use by metal construction companies in Germany and beyond. A wealth of other profiles have been developed, with the range being expanded systematically.

Parallel to the standard products, profile systems were introduced at a very early stage – systems designed for specific applications in both fire protection and in safety and security. RP Technik recognised the needs of commercial construction early on, and opted for the outstanding material properties and processing properties of steel and stainless steel right from the start. This decision led to close cooperation with Welser Profile, the world's leading manufacturer of cold-rolled

steel profiles. In 2000, RP Technik became a member of the Welser Profile group, allowing the company to respond even more quickly and flexibly to the needs of the market. Now, with production facilities in Austria and Germany, top quality from the technology leader is guaranteed and ultra-fast response times are ensured.

RP Technik has worldwide partnership structures at its disposal for global sales and distribution, forming a close-knit network guaranteeing the high standards of RP Technik in after-sales service and support at the international level. This encompasses assistance in compiling cost estimates, shared presentations at trade shows in the area, product training for customers and users, and support for tendering.

Moreover, RP Technik's development team is focusing increasingly on developing customised products and systems, on the basis of more than 100 years of experience, backed up by the brand power of the market leader, Welser Profile. RP Technik's workforce, currently numbering 63 employees, is guided by the market and its specific needs at every step of the development process, with dedicated expert consultation directly with you at your premises if required.

Because „experienced service and dedicated support“ is a principle which the RP Technik specialists live by every day.

„Our many years of experience and thorough knowledge of the market provide you with first-rate expert advice you can rely on.“

Patrik Kleebaum  
Corporate management





## Table of contents

Close contact with customers to understand their needs is the primary goal of RP Technik's specialist staff – as demonstrated daily in theoretical and practical training sessions, courses and consulting – whether in RP Technik's training facilities or on your premises.

### profile systems

<b>Curtain wall systems</b>		
4	RP-ISO-hermetic 45N	
5	RP-ISO-hermetic 60N	
6	RP-tec 55	
<b>Add-on curtain wall systems</b>		
8	RP-tec 50-1 / 50-1 plus / 50-1 HA / 50-1 HA plus	
9	RP-tec 55-1 / 55-1 plus / 55-1 HA / 55-1 HA plus	
10	RP-tec 60-1 / 60-1 HA	
11	RP-tec 80-1 / 80-1 HA	
<b>Thermally insulated door, window and partition wall systems</b>		
14	RP-ISO-hermetic 70 / 70 plus	
16	RP-ISO-FINELINE	
<b>Non-thermally insulated door and window systems</b>		
20	RP-hermetic 55N	
22	RP-hermetic FINELINE	
<b>Safety systems</b>		
<i>Fire protection</i>		
26	RP-hermetic FINELINE E(W) 30	
27	RP-hermetic 55N FP E(W) 30-90	
30	RP-ISO-hermetic 70 FP EI 30-90	
32	RP-ISO-hermetic EI 120	
34	RP-ISO-hermetic 45N EI 30-120 / E (W) 30	
35	RP-ISO-hermetic 60N EI 30-120 / E (W) 30	
<i>Bullet-resistance</i>		
37	RP-hermetic 75 FB4 / FB6	
39	RP-ISO-hermetic 60N FB7	

### the steel line – RP standard profile

40	RP standard profile	
----	---------------------	--

### profile services

42	Experienced service & dedicated support
43	Overview of profile systems and evidence of tests

Functionality meets transparency

## Curtain wall systems

RP-ISO-hermetic 45N / RP-ISO-hermetic 60N / RP-tec 55

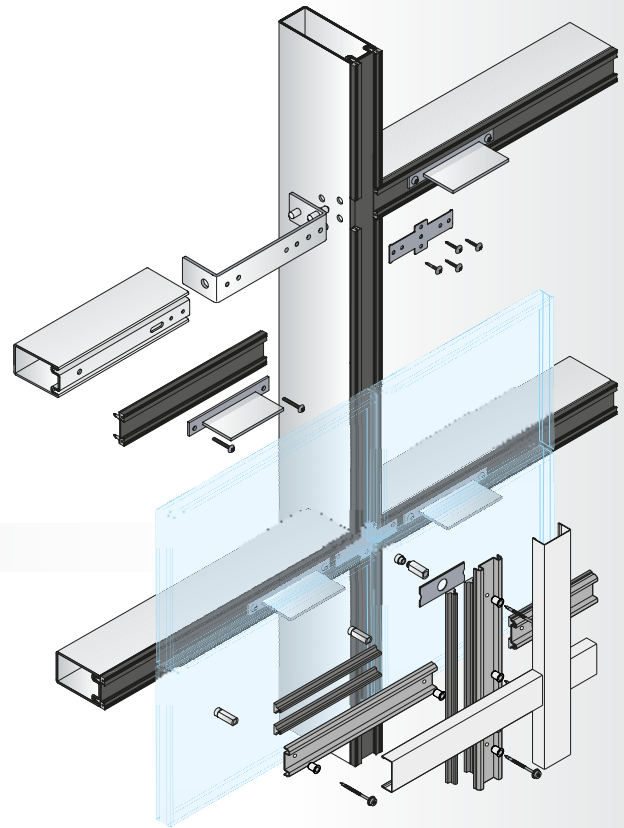



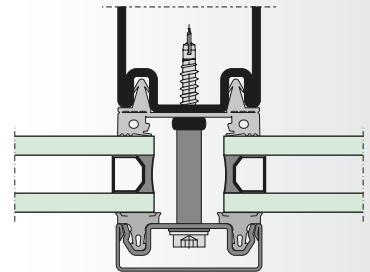
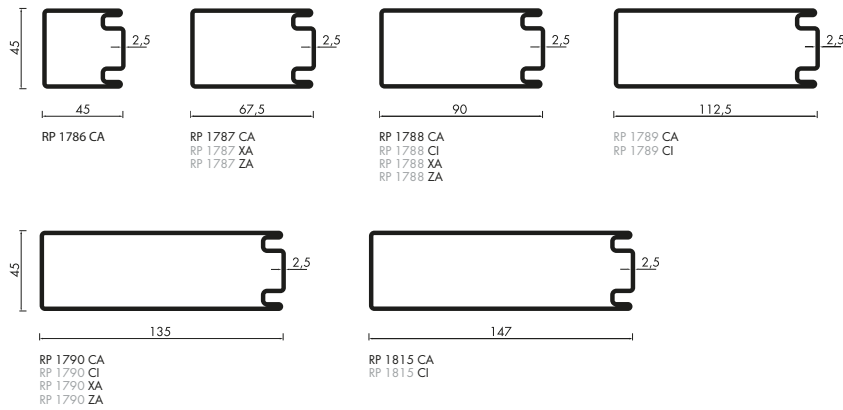

### RP-ISO-hermetic 45N - Profile overview

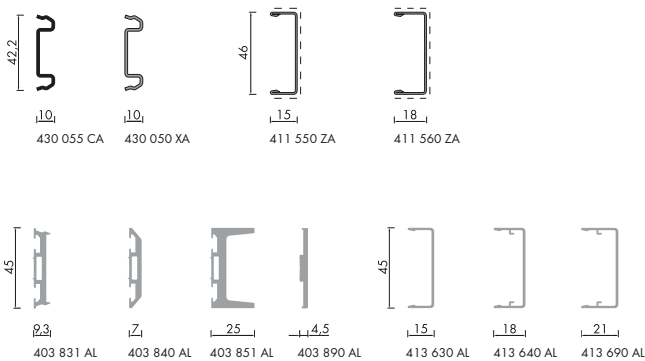

### Pressure profile / Cover profile

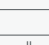

RP-ISO-hermetic 45N	
	Curtain walls
	Add-on curtain wall system
	Doors
	Partition walls
	Windows
	Sliding elements

### Evidence

When using the profile systems, the relevant national requirements, guidelines and building regulations must be observed while taking into account any available test evidence and recognition thereof.

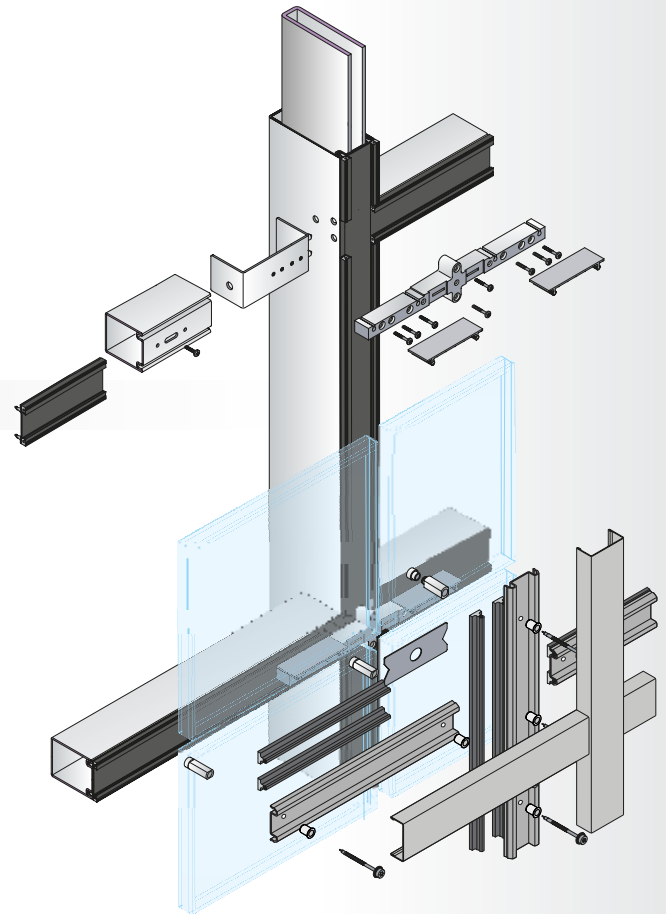

**RP-ISO-hermetic 60N - Profile overview**

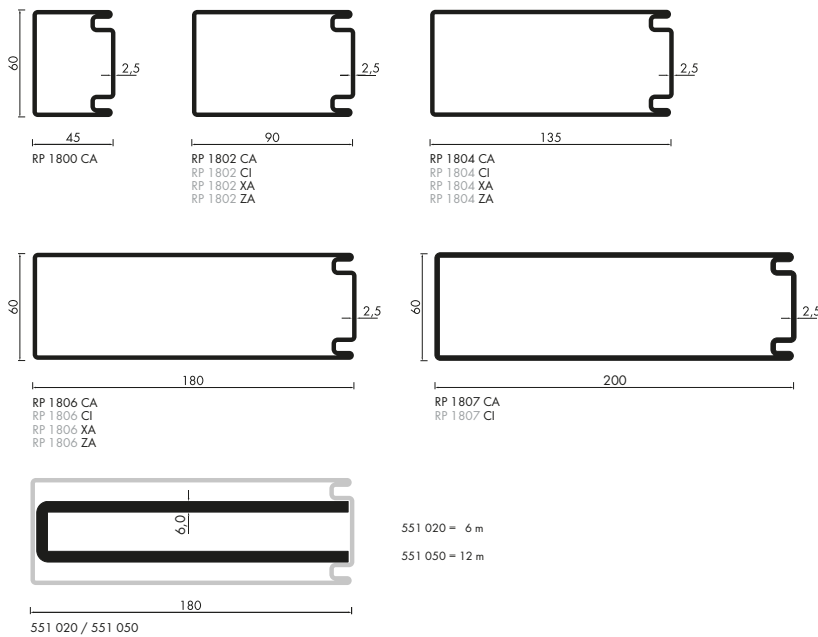

**Pressure profile / Cover profile**

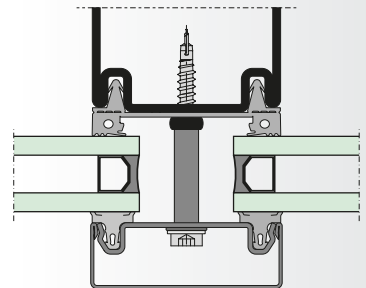
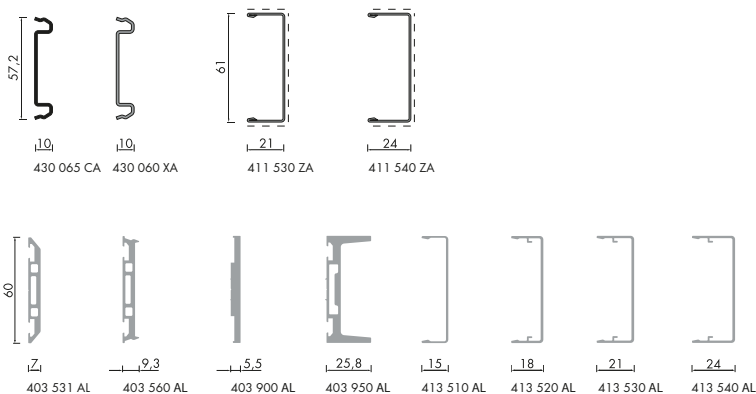

**RP-ISO-hermetic 60N**

	● Curtain walls
	Add-on curtain wall system
	Doors
	Partition walls
	Windows
	Sliding elements

**Evidence**

When using the profile systems, the relevant national requirements, guidelines and building regulations must be observed while taking into account any available test evidence and recognition thereof.

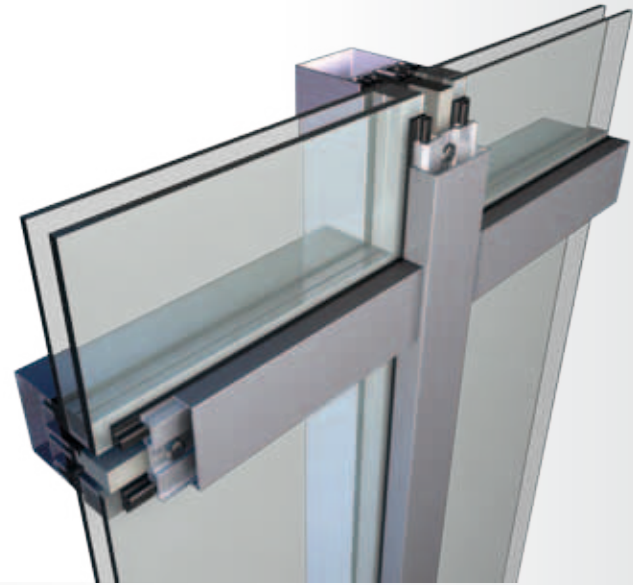

## RP-tec 55 / 55 plus - Profile overview

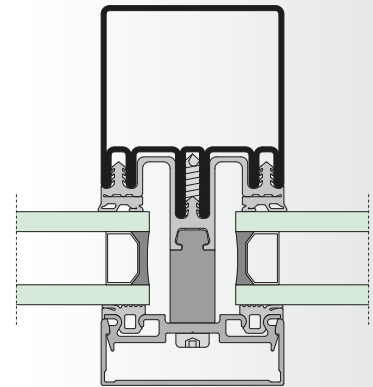
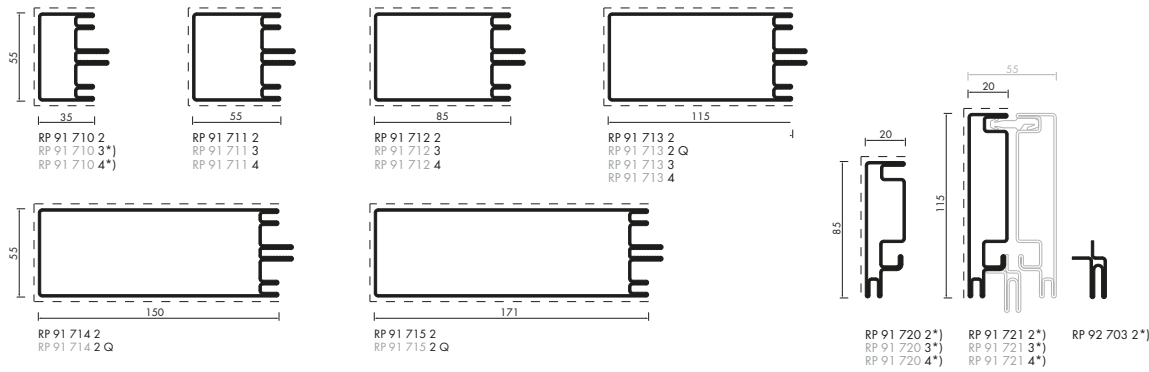

## Pressure profile / Cover profile

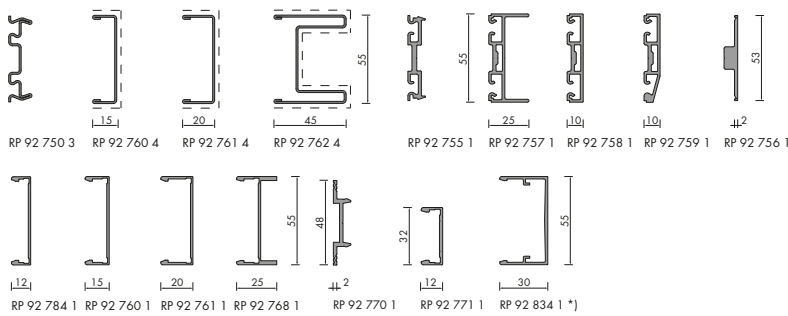

RP-tec 55	
	<input checked="" type="checkbox"/> Curtain walls
	<input type="checkbox"/> Add-on curtain wall system
	<input type="checkbox"/> Doors
	<input type="checkbox"/> Partition walls
	<input type="checkbox"/> Windows
	<input type="checkbox"/> Sliding elements

### Evidence

When using the profile systems, the relevant national requirements, guidelines and building regulations must be observed while taking into account any available test evidence and recognition thereof.

## Advantages:

- Three times the load-carrying capacity of aluminium, allowing large span widths/lengths
- Narrow elevation widths of 45 to 60 mm
- Innovative screw/plug connection for easier utilisation
- Vertical and polygonal versions possible
- RP-ISO-hermetic 45N / 60N and RP-tec 55, a range of systems for all applications: thermal insulation, fire protection, general safety and security



1+2

Rösraht cultural centre,  
Germany





Variety with an appealing design

## Add-on curtain wall system

RP-tec 50-1 / 50-1 plus / 50-1 HA / 50-1 HA plus  
 RP-tec 55-1 / 55-1 plus / 55-1 HA / 55-1 HA plus  
 RP-tec 60-1 / 60-1 HA  
 RP-tec 80-1 / 80-1 HA

### RP-tec 50-1 / 50-1 plus / 50-1 HA / 50-1 HA plus – System sections

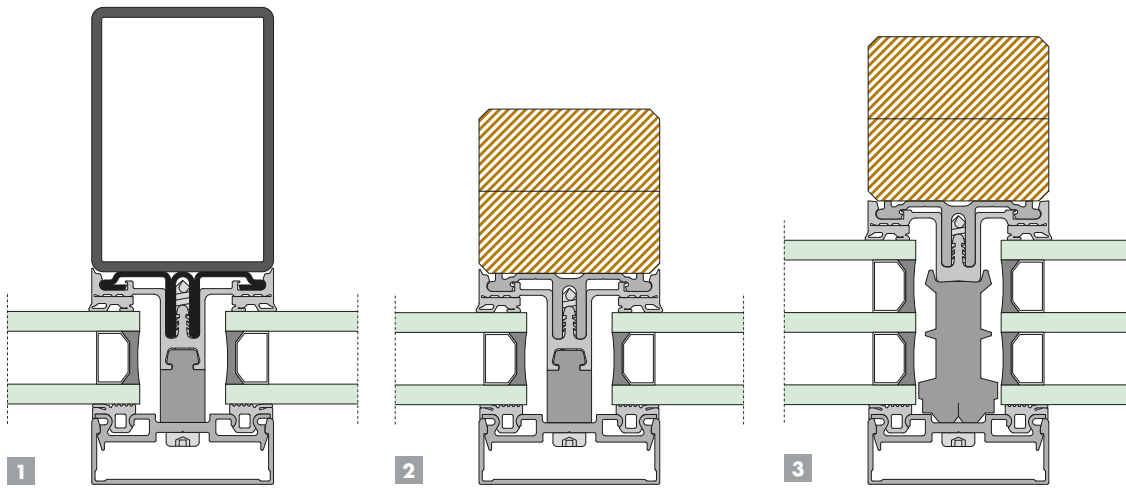

<b>RP-tec 50-1</b>		<b>1</b>
		Curtain walls
		<input checked="" type="checkbox"/> Add-on curtain wall system
		Doors
		Partition walls
		Windows
		Sliding elements
<b>RP-tec 50-1 HA</b>		<b>2</b>
		Curtain walls
		<input checked="" type="checkbox"/> Add-on curtain wall system
		Doors
		Partition walls
		Windows
		Sliding elements
<b>RP-tec 50-1 HA plus</b>		<b>3</b>
		Curtain walls
		<input checked="" type="checkbox"/> Add-on curtain wall system
		Doors
		Partition walls
		Windows
		Sliding elements

### RP-tec 50-1 / 50-1 plus / 50-1 HA / 50-1 HA plus – Profile overview

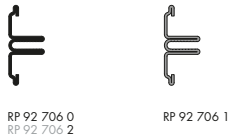

### Pressure profile / Cover profile

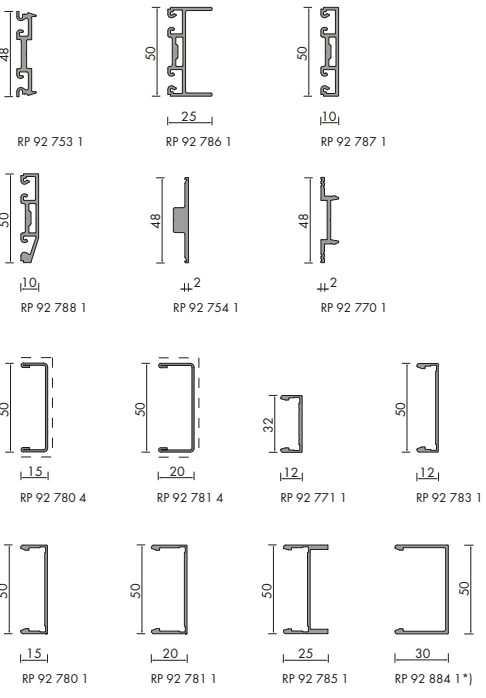

### Evidence

When using the profile systems, the relevant national requirements, guidelines and building regulations must be observed while taking into account any available test evidence and recognition thereof.







## RP-tec 55-1 / 55-1 plus / 55-1 HA / 55-1 HA plus – System sections

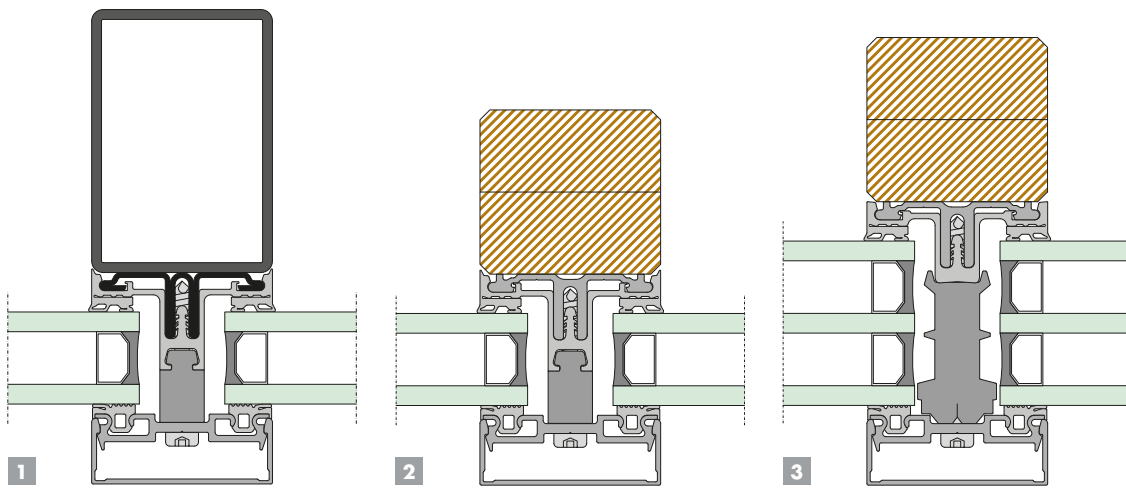

## RP-tec 55-1 / 55-1 plus / 55-1 HA / 55-1 HA plus – Profile overview

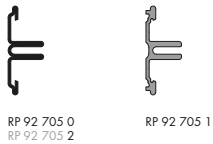

### Pressure profile / Cover profile

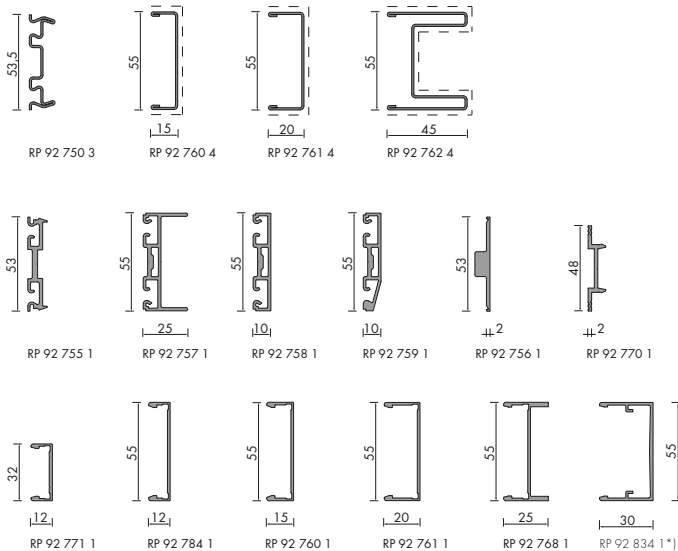

RP-tec 55-1		1
		Curtain walls
		Doors
		Windows
		Sliding elements
RP-tec 55-1 HA		2
		Curtain walls
		Doors
		Windows
		Sliding elements
RP-tec 55-1 HA plus		3
		Curtain walls
		Doors
		Windows
		Sliding elements

### Evidence

When using the profile systems, the relevant national requirements, guidelines and building regulations must be observed while taking into account any available test evidence and recognition thereof.



## RP-tec 60-1 / 60-1 HA - System sections

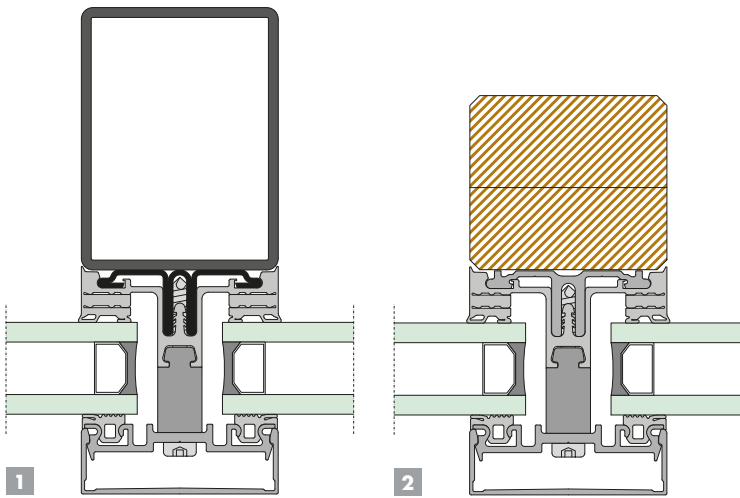

## RP-tec 60-1 / 60-1 HA - Profile overview

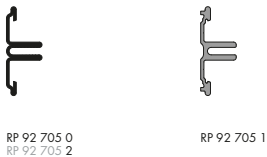

## Pressure profile / Cover profile

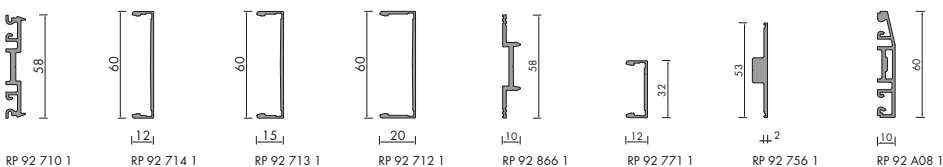

RP-tec 60-1		1
		Curtain walls
		Doors
		Partition walls
		Windows
		Sliding elements
RP-tec 60-1 HA		2
		Curtain walls
		Doors
		Partition walls
		Windows
		Sliding elements

### Evidence

When using the profile systems, the relevant national requirements, guidelines and building regulations must be observed while taking into account any available test evidence and recognition thereof.



## RP-tec 80-1 / 80-1 HA - System sections

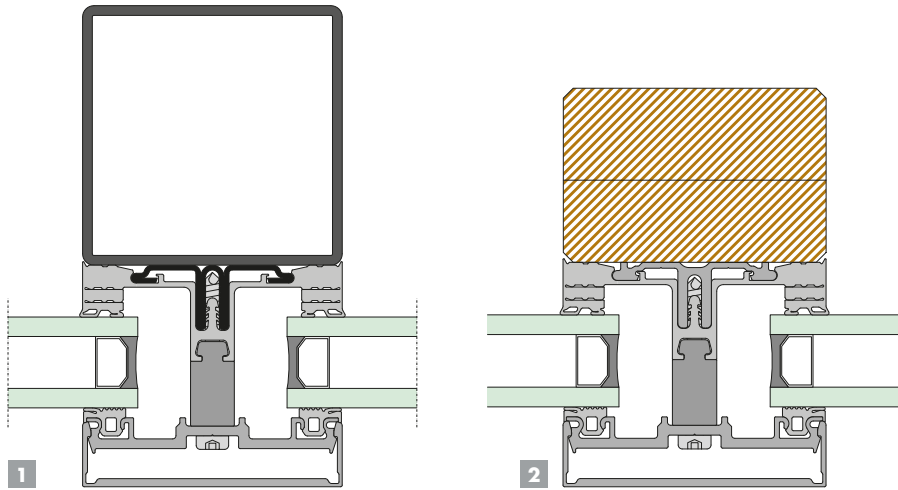

## RP-tec 80-1 / 80-1 HA - Profile overview

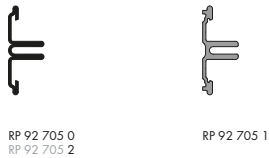

## Pressure profile / Cover profile

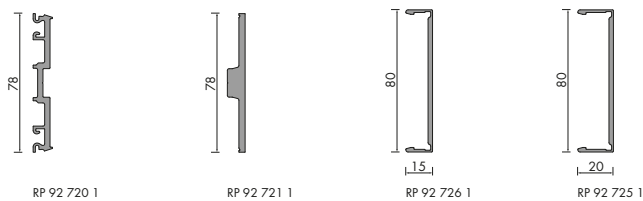

RP-tec 80-1	<b>1</b>
	<ul style="list-style-type: none"> <li>— Curtain walls</li> <li>● Add-on curtain wall system</li> <li>— Doors</li> <li>— Partition walls</li> <li>— Windows</li> <li>— Sliding elements</li> </ul>
RP-tec 80-1 HA	<b>2</b>
	<ul style="list-style-type: none"> <li>— Curtain walls</li> <li>● Add-on curtain wall system</li> <li>— Doors</li> <li>— Partition walls</li> <li>— Windows</li> <li>— Sliding elements</li> </ul>

### Evidence

When using the profile systems, the relevant national requirements, guidelines and building regulations must be observed while taking into account any available test evidence and recognition thereof.

## Advantages:

- Possible elevation widths: 50, 55, 60 and 80 mm
- Straight-line and polygonal arrangement
- Heated curtain walls
- Advanced connection techniques
- Thermal transmission coefficient ( $U_i$ ) to 0.7 W/m<sup>2</sup>K, suitable for passive houses
- VI-plus panel as innovative insulating element
- Modular system structure for greater ease of use
- Nail fastening system
- Hilti sheet metal nail technology
- Screwed joints
- MAG plug welds
- Tested transom connection for wooden siding or cladding
- Guided inner seal → no buckling or waviness



1+2

Spiegel headquarters,  
Hamburg, Germany





3+4

O2 World, Berlin,  
Germany



Large-area coverage, attractive and highly insulating

## Thermally insulated door, window and partition wall systems

RP-ISO-hermetic 70 / 70 plus

### RP-ISO-hermetic 70 / 70 plus - Profile overview

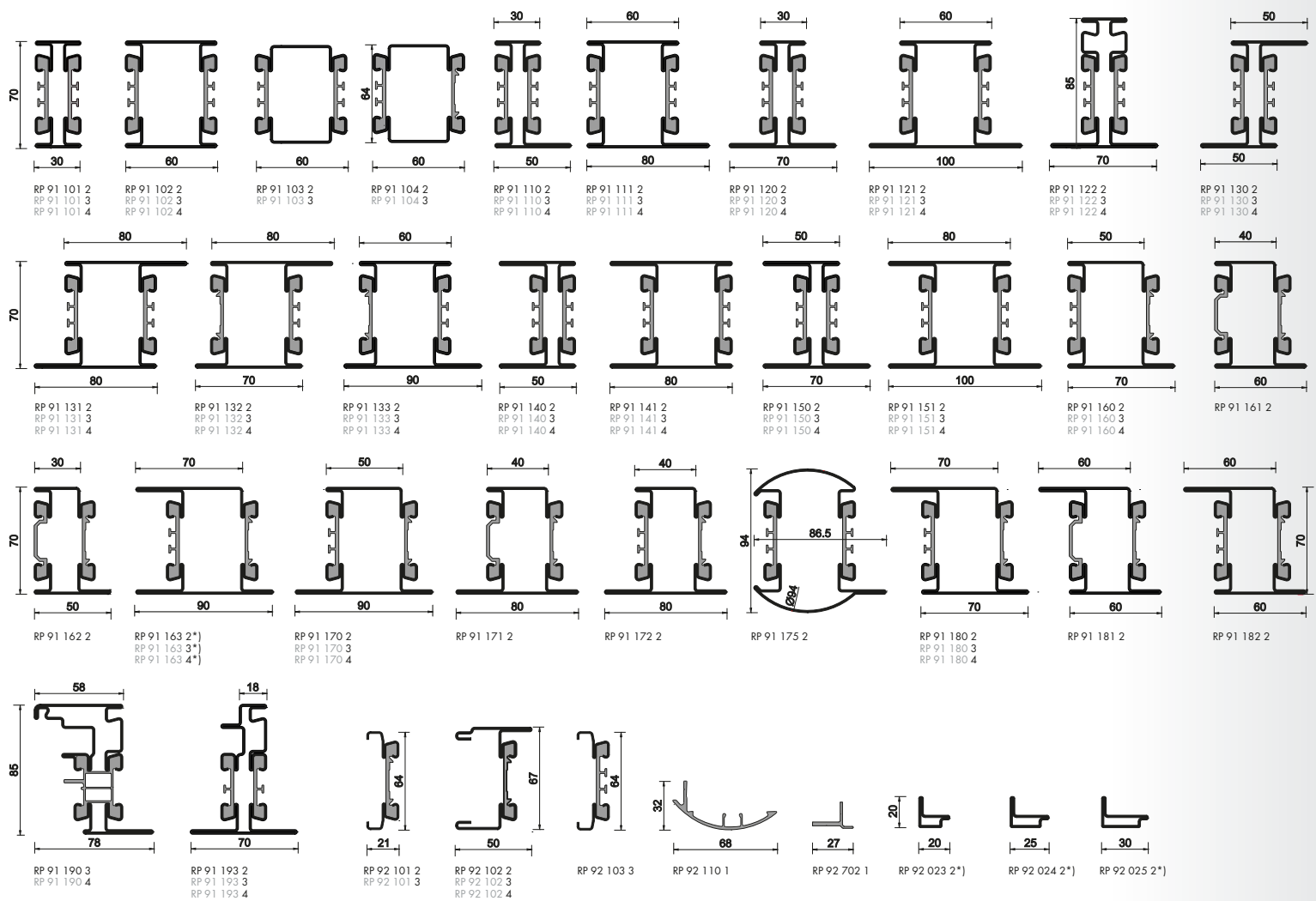

### Glazing beads

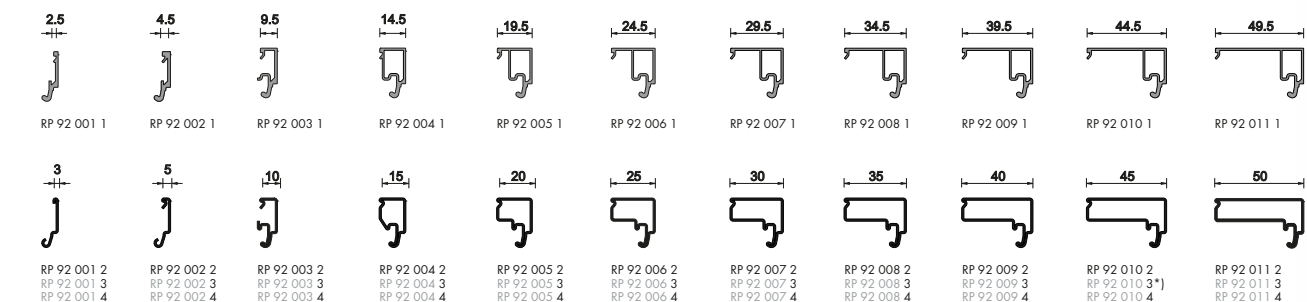

## RP-ISO-hermetic 70 / 70 plus - System sections

### 1 Doors

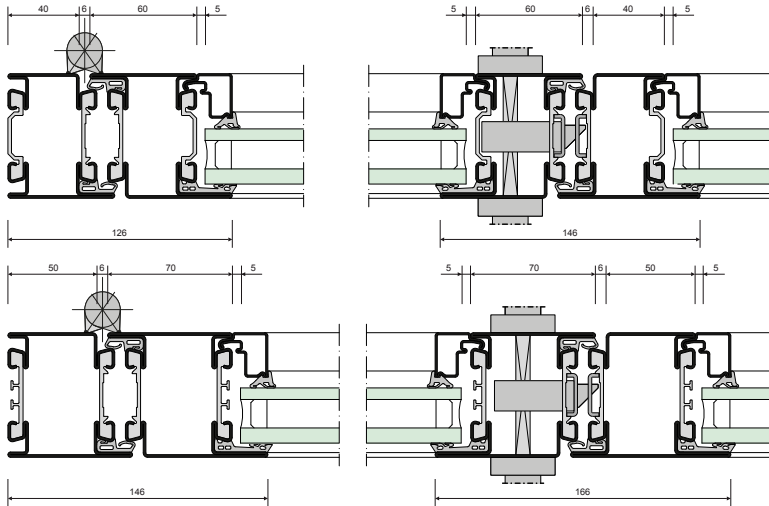

### 1 Partition walls

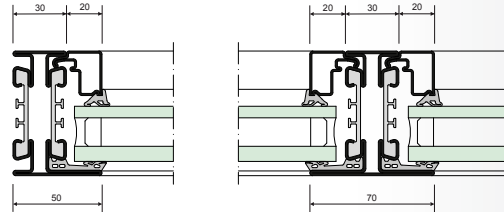

### 2 Windows

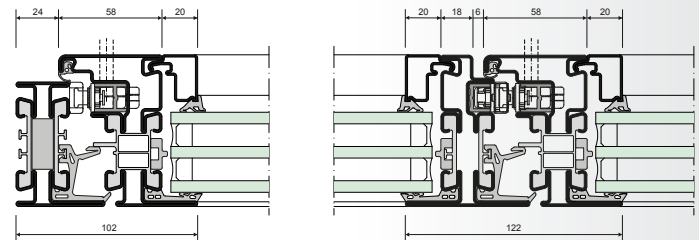

### 1 Doors with finger trap protection

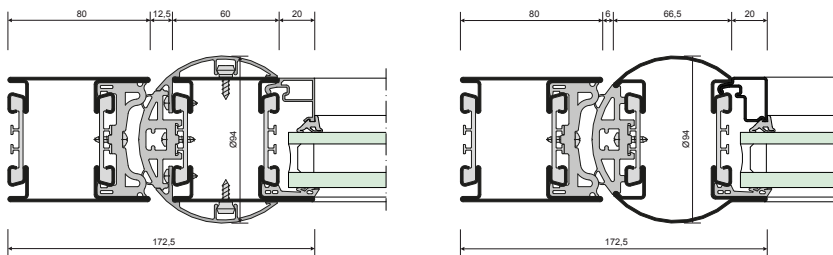

### 1 Doors

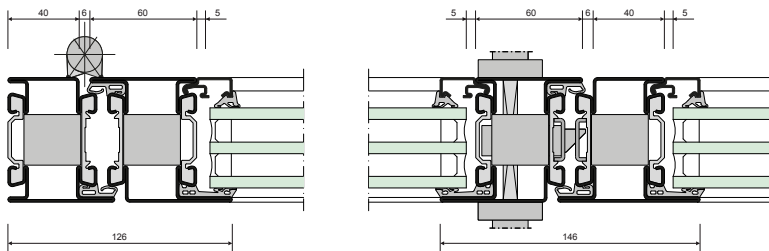

RP-ISO-hermetic 70 / 70 plus		1
	Curtain walls	
	Add-on curtain wall system	
	Doors	<input checked="" type="checkbox"/>
	Partition walls	<input checked="" type="checkbox"/>
	Windows	<input type="checkbox"/>
	Sliding elements	<input type="checkbox"/>

RP-ISO-hermetic 70 / 70 plus		2
	Curtain walls	<input type="checkbox"/>
	Add-on curtain wall system	<input type="checkbox"/>
	Doors	<input checked="" type="checkbox"/>
	Partition walls	<input type="checkbox"/>
	Windows	<input checked="" type="checkbox"/>
	Sliding elements	<input type="checkbox"/>

### Evidence

When using the profile systems, the relevant national requirements, guidelines and building regulations must be observed while taking into account any available test evidence and recognition thereof.

### Advantages:

- 1- and 2-leaf doors, windows and partition walls in steel and stainless steel 1.4401 (316)
- Compatible with all other RP door, window and curtain wall systems
- Also available as door with finger protection gaskets
- Extensive range of fixtures and accessories
- Highly insulating solution with insulators
- Simplified, highly insulating solution for 1- and 2-leaf windows
- Innovative corrosion protection with zinc-magnesium hot-dip coating

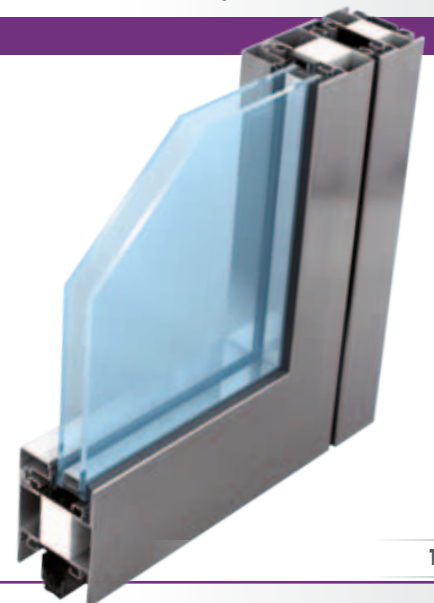

## Thermal insulation and narrow widths

### Thermally insulated window and partition wall systems

RP-ISO-FINELINE

#### RP-ISO-FINELINE - Profile overview

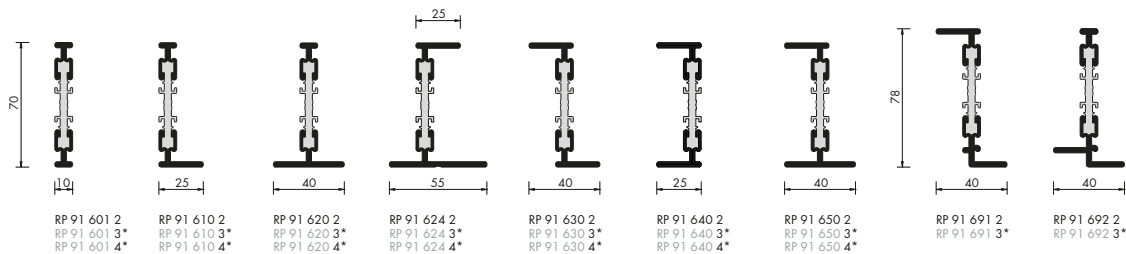

#### Glazing beads

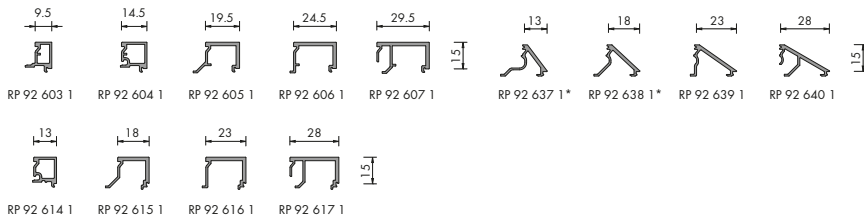

#### Accessories

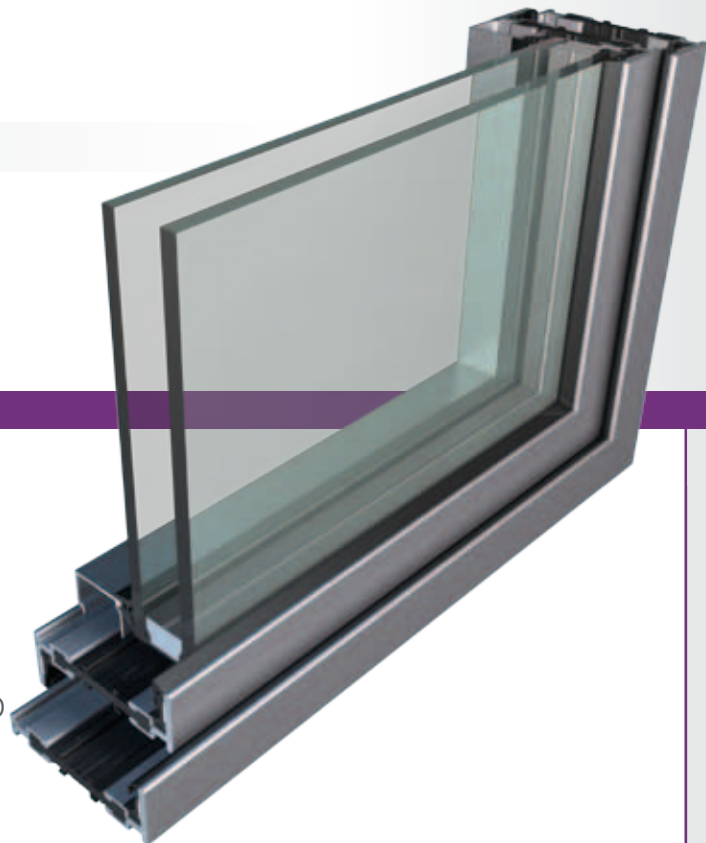
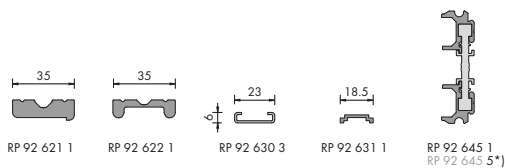

#### Advantages:

- Low thermal transmission coefficient ( $U_t$ )
- Glass thickness up to 48 mm
- A variety of window types and opening styles are possible
- Very narrow widths
- Various glazing bead contours
- Special geometries, bending radii of 300 mm possible
- Concealed drainage
- Construction depth of 70 mm, combinable with RP-ISO-hermetic 70
- Variety of fittings options, from nostalgic to modern
- Easy to use as no additional strips are required
- Glazing bead clips in without any additional fasteners
- Quick and simple welding due to recessed insulators



**RP-ISO-FINELINE - System sections**

**Section A-B**

Option with standard glazing bead

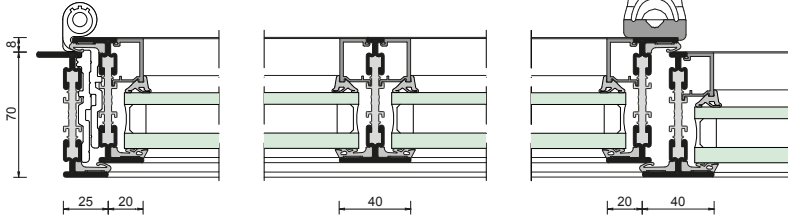

**Section A**

Option with inclined glazing bead

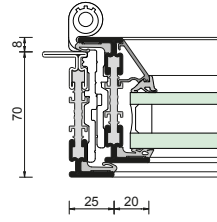

**Section A**

Highly insulated "plus" option

Side-hung casement with side panel inwards

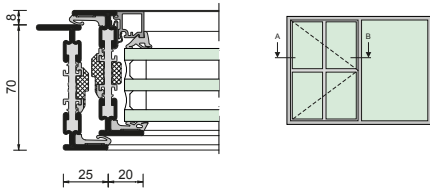

**Section J**

Double casement leaf, centre joint inwards

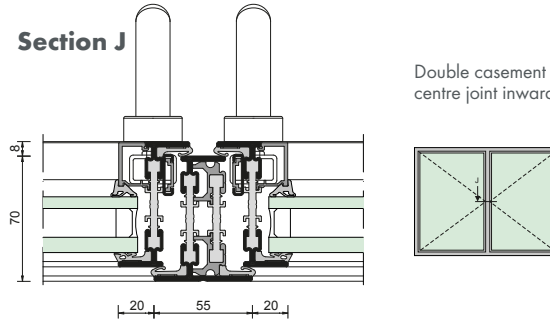

**Section C-D**

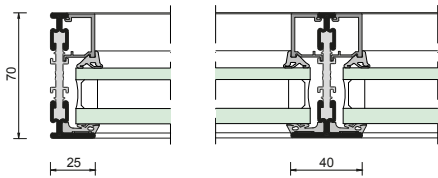

Fixed glazing

Double casement leaf with middle sash profile for inward opening

Side-hung casement outwards with side part

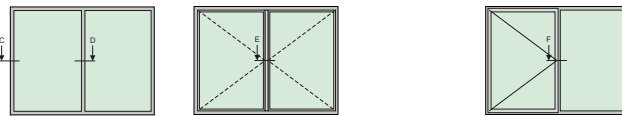

**Section E**

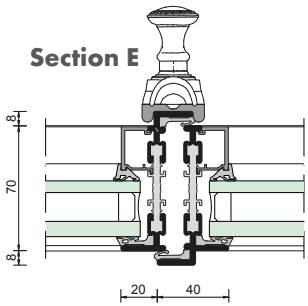

**Section F**

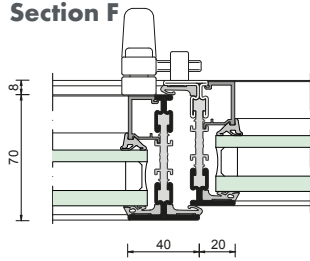

**Section I**

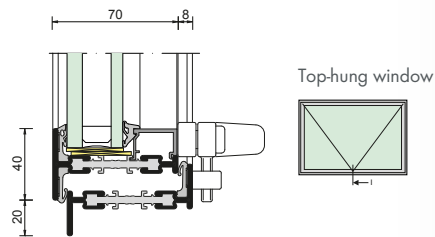

**Section G-H**

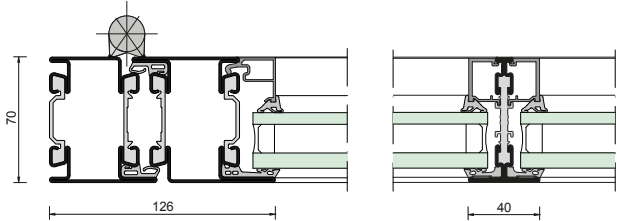

Combination with door system RP-ISO-hermetic 70

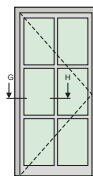

**Section B**

Option with concealed fitting

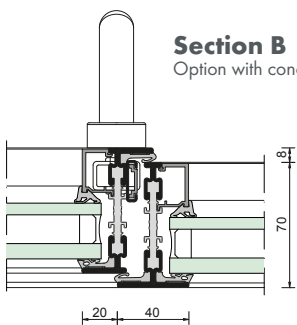

**RP-ISO-FINELINE**

	Curtain walls
	Add-on curtain wall system
	Doors
	Partition walls
	Windows
	Sliding elements

**Evidence**

When using the profile systems, the relevant national requirements, guidelines and building regulations must be observed while taking into account any available test evidence and recognition thereof.



1+2

Central library, Munich,  
Germany





3+4

Private Villa, Mainz,  
Germany



Functional, long lasting and with narrow elevation widths

## Non-thermally insulated door, window and partition wall systems

RP-hermetic 55N

### RP-hermetic 55N - Profile overview

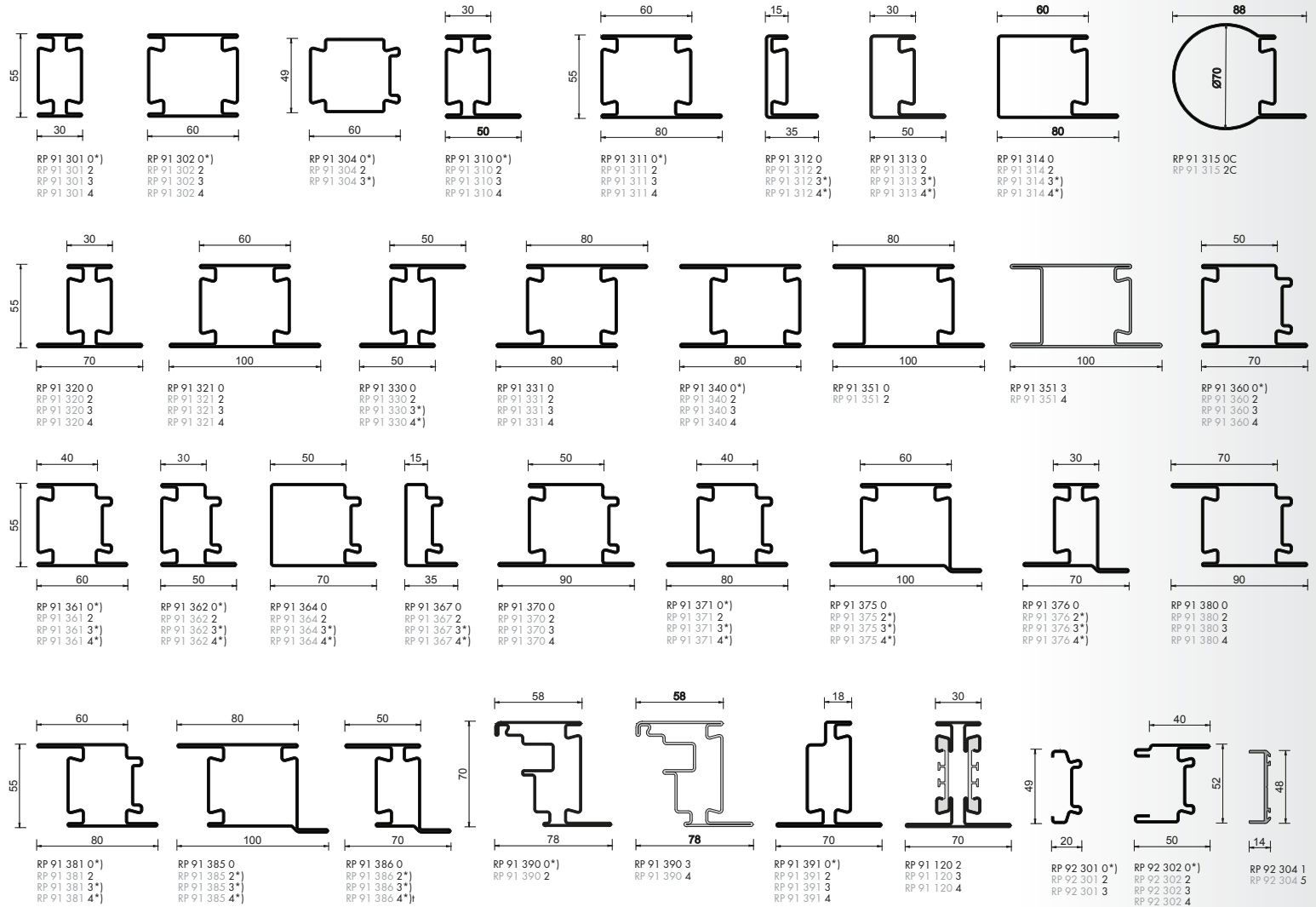

### Glazing beads

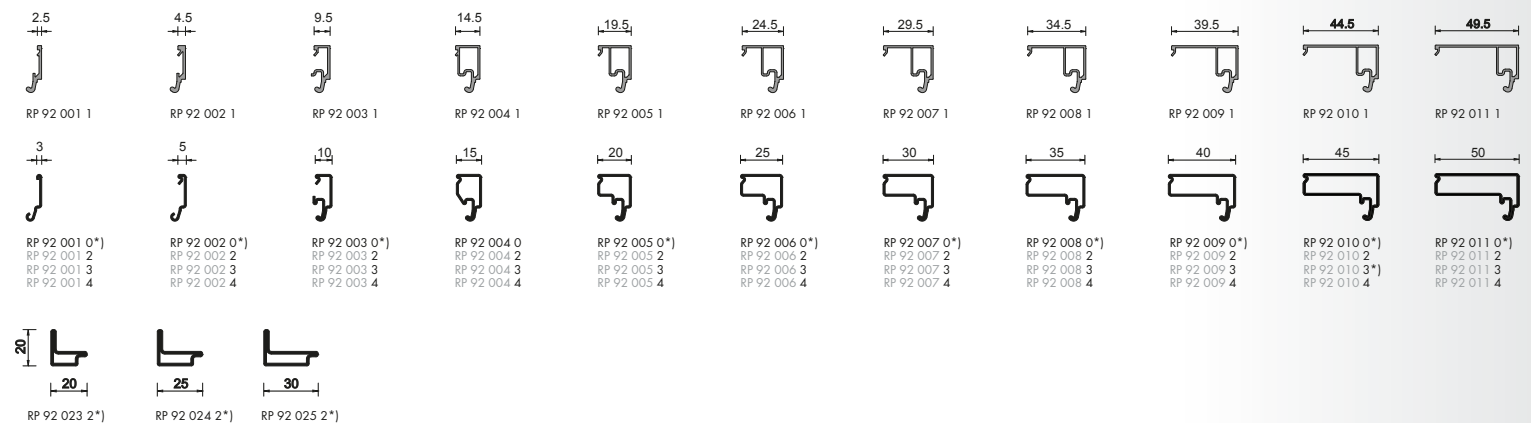

## RP-hermetic 55N – System sections

### 2 Windows

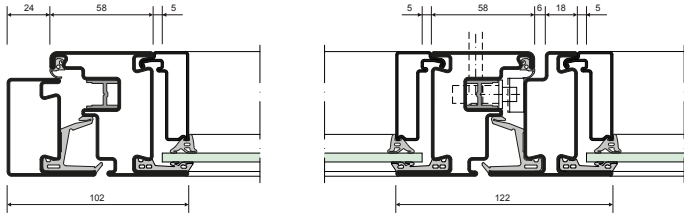

### 1 Partition walls

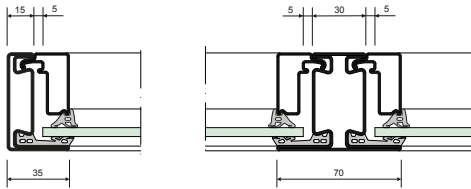

### 1 Doors

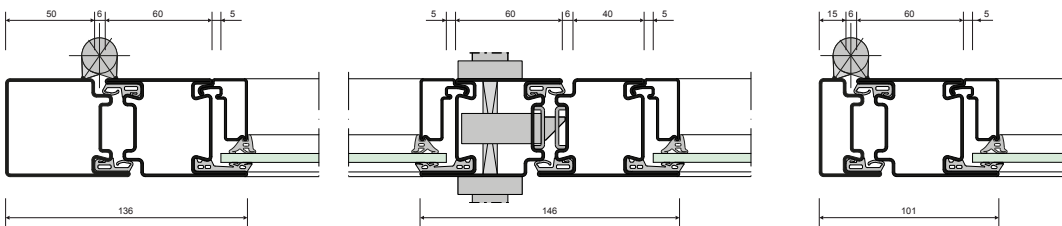

### 1 Doors with finger trap protection

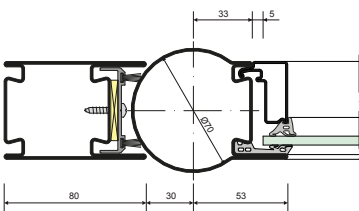

RP-hermetic 55N		1
	Curtain walls	
	Add-on curtain wall system	
	Doors	
	Partition walls	
	Windows	
	Sliding elements	
RP-hermetic 55N		2
	Curtain walls	
	Add-on curtain wall system	
	Doors	
	Partition walls	
	Windows	
	Sliding elements	

### Evidence

When using the profile systems, the relevant national requirements, guidelines and building regulations must be observed while taking into account any available test evidence and recognition thereof.

### Advantages:

- 1- and 2-leaf doors, windows and partition walls in steel and stainless steel 316 (1.4401)
- Easy utilisation
- Can be installed as smoke protection door with the same elevation widths
- Available as door with finger protection gaskets
- Wide range of profiles
- Extensive range of fixtures and accessories
- Innovative corrosion protection with zinc-magnesium hot-dip coating

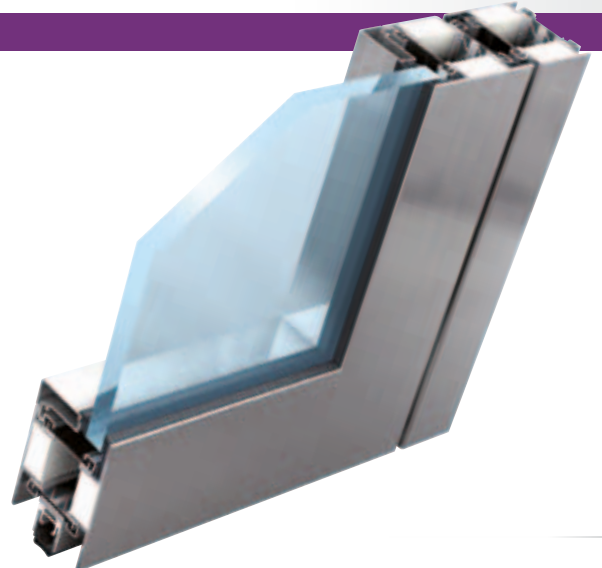

Narrow elevation widths for listed historic buildings  
 and attractive architecture

## Non-thermally insulated window and partition systems & sliding elements

RP-hermetic FINELINE

### RP-hermetic FINELINE – Profile overview

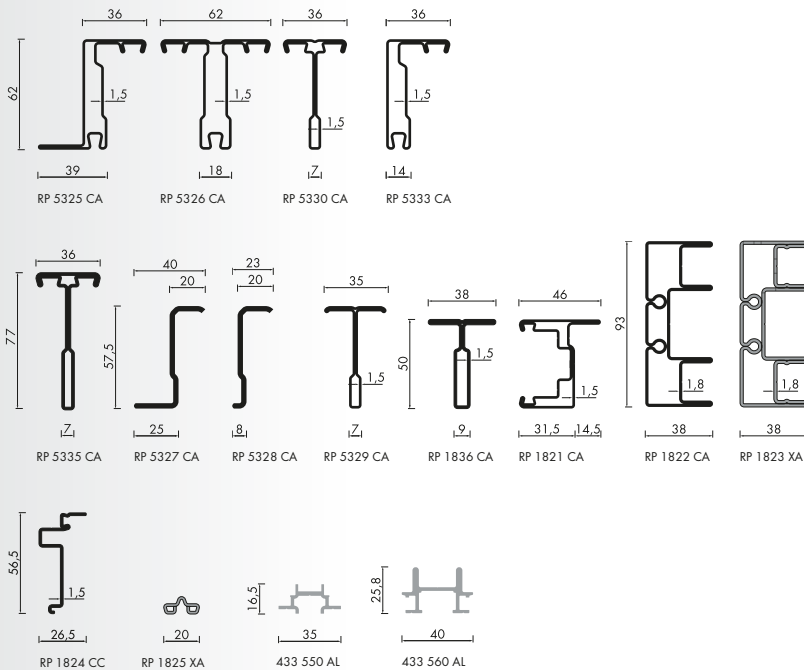

### Glazing beads

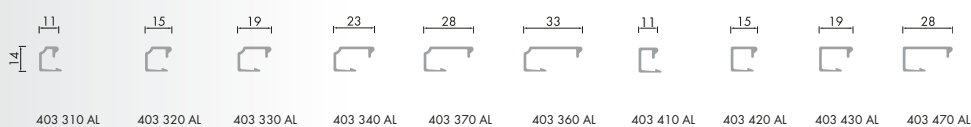

## RP-hermetic FINELINE – System sections

### 1 Windows

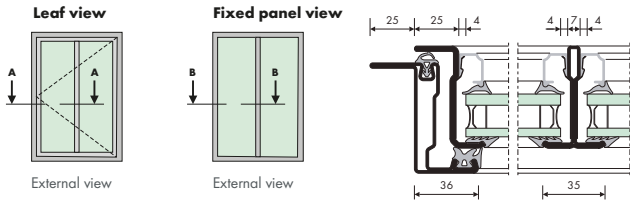

### 2 Sliding element variants

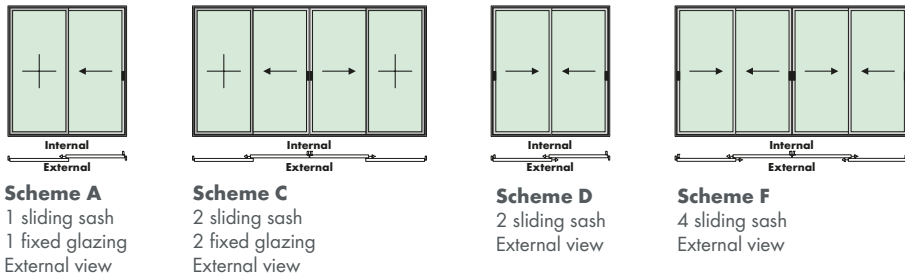

### Section B - B

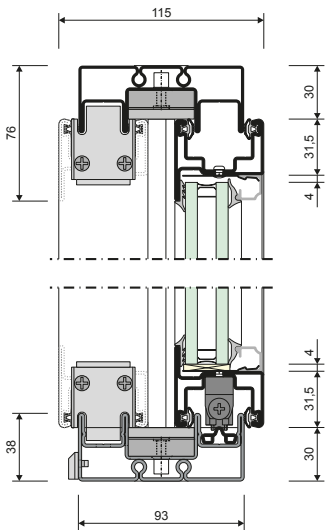

### Section A - A

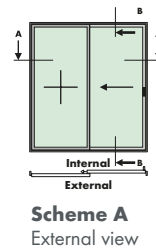
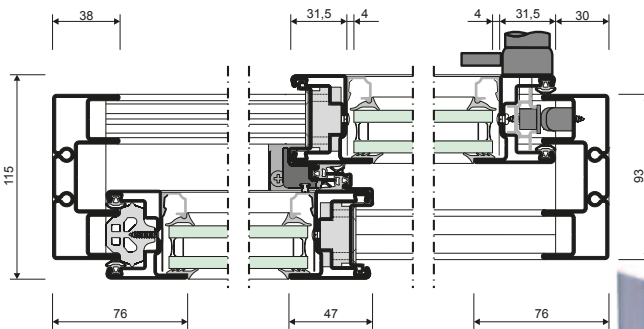

Phone: (08) 9399 6957  
 Address: 17 Williams Road Kelmscott WA 6111  
 Email: Sales@AustralianFireControl.com.au  
 Postal: PO BOX 1008 DC Kelmscott WA 6997  
 www.australianFireControl.com.au

RP-hermetic FINELINE 1	
	Curtain walls
	Add-on curtain wall system
	Doors
	Partition walls
	Windows
	Sliding elements
RP-hermetic FINELINE 2	
	Curtain walls
	Add-on curtain wall system
	Doors
	Partition walls
	Windows
	Sliding elements

### Evidence

When using the profile systems, the relevant national requirements, guidelines and building regulations must be observed while taking into account any available test evidence and recognition thereof.

### Advantages:

- Attractive and modern design due to narrow elevation widths of just 36 mm
- Glass surfaces of maximum size
- Ideal for use in listed historic buildings and buildings with historic character
- Can be implemented as turn window, double casement window and tilting transom
- Fittings from nostalgic to modern





1+2

Carreau du Temple, Paris  
France







3+4

Apartment house, Munich,  
Germany



# Safety systems

## -fire and smoke protection

### Non-thermally insulated door and partition wall systems

RP-hermetic FINELINE E(W) 30 and RP-hermetic 55N FP E(W) 30-90

#### RP-hermetic FINELINE E(W) 30 – Profile overview

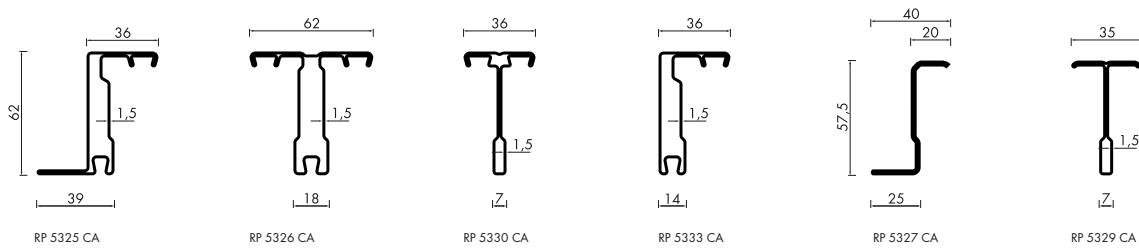



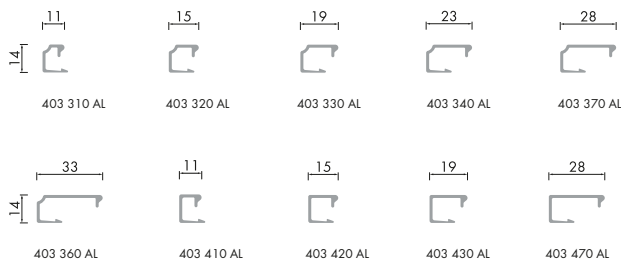

#### Glazing beads

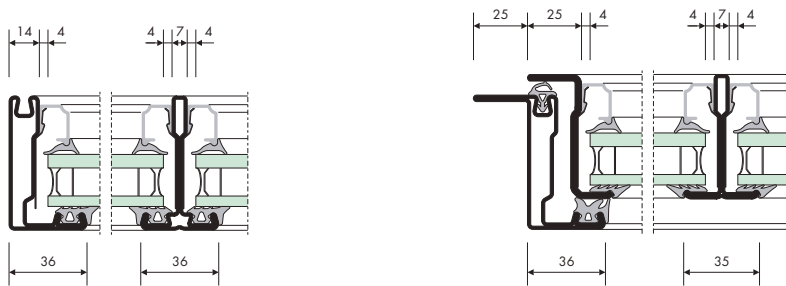

#### RP-hermetic FINELINE E(W) 30 – System sections

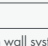

Phone: (08) 9399 6957  
 Address: 17 Williams Road Kelmscott WA 6111  
 Email: Sales@AustralianFireControl.com.au  
 Postal: PO BOX 1008 DC Kelmscott WA 6997  
 www.australianFireControl.com.au

RP-hermetic FINELINE E(W) 30	
	Curtain walls
	Add-on curtain wall system
	Doors
	Partition walls
	Windows
	Sliding elements

#### Evidence

When using the profile systems, the relevant national requirements, guidelines and building regulations must be observed while taking into account any available test evidence and recognition thereof.

#### Advantages:

- Attractive and modern design due to narrow elevation widths of just 36 mm
- Glass surfaces of maximum size
- Ideal for use in listed historic buildings and buildings with historic character
- Can be implemented as turn window, double casement window and tilting transom
- Fittings from nostalgic to modern
- Effective fire protection in classes E and EW

## RP-hermetic 55N FP E(W) 30-90 – Profile overview

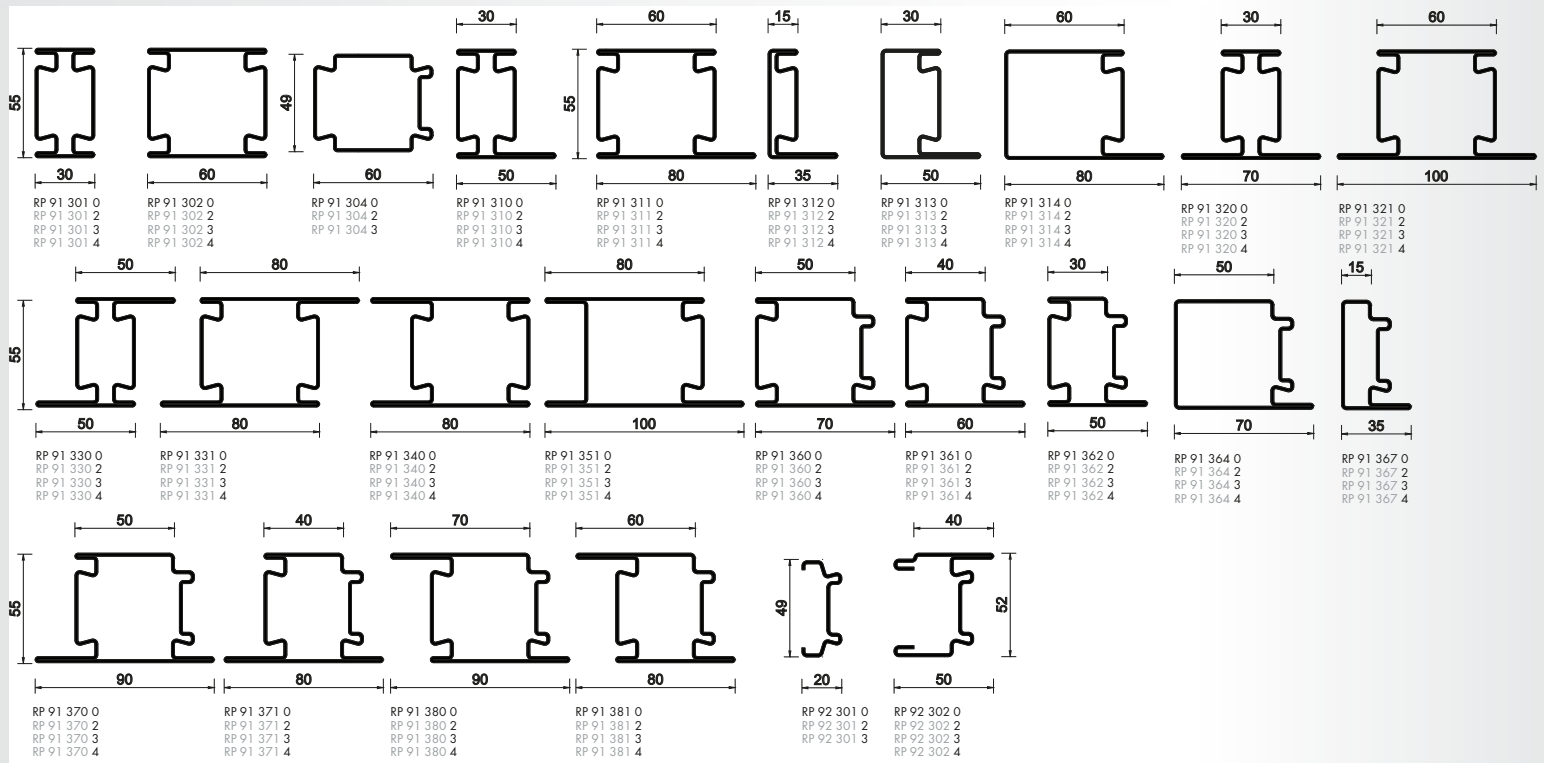

### Glazing beads

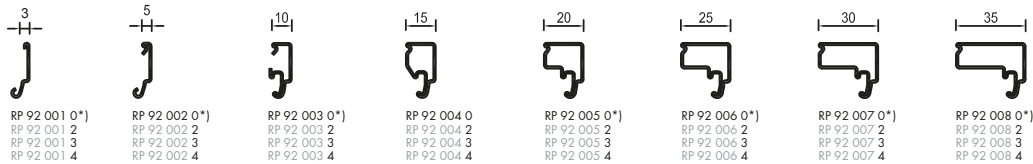

## RP-hermetic 55N FP E(W) 30-90 – System sections

### Doors

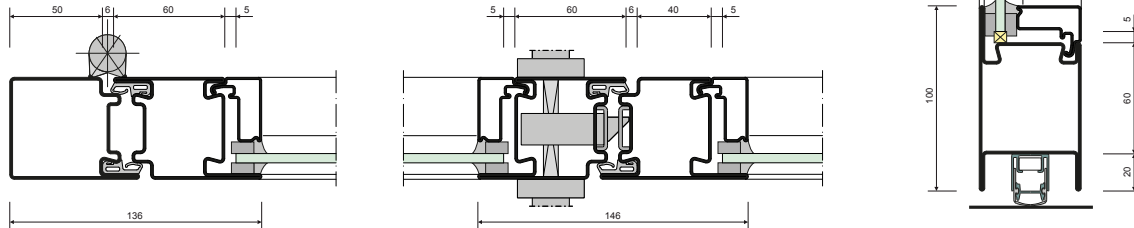

### Fixed glazing

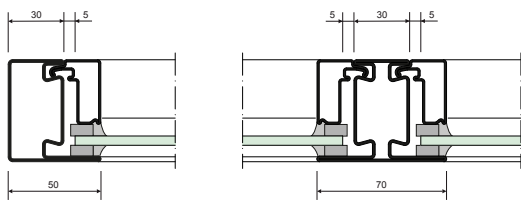

### RP-hermetic 55N FP E(W) 30-90

	Curtain walls
	Add-on curtain wall system
	Doors
	Partition walls
	Windows
	Sliding elements

### Evidence

When using the profile systems, the relevant national requirements, guidelines and building regulations must be observed while taking into account any available test evidence and recognition thereof.

### Advantages:

- 1- and 2-leaf doors and partition walls in steel and stainless steel 316 (1.4401)
- Easy utilisation
- Can be installed as smoke protection door with the same elevation widths
- Wide range of profiles
- Extensive range of fixtures and accessories
- Innovative corrosion protection with zinc-magnesium hot-dip coating



1+2

Hannover Exhibition Center,  
Germany





3+4

*Kameha Grand Hotel,  
Bonn, Germany*

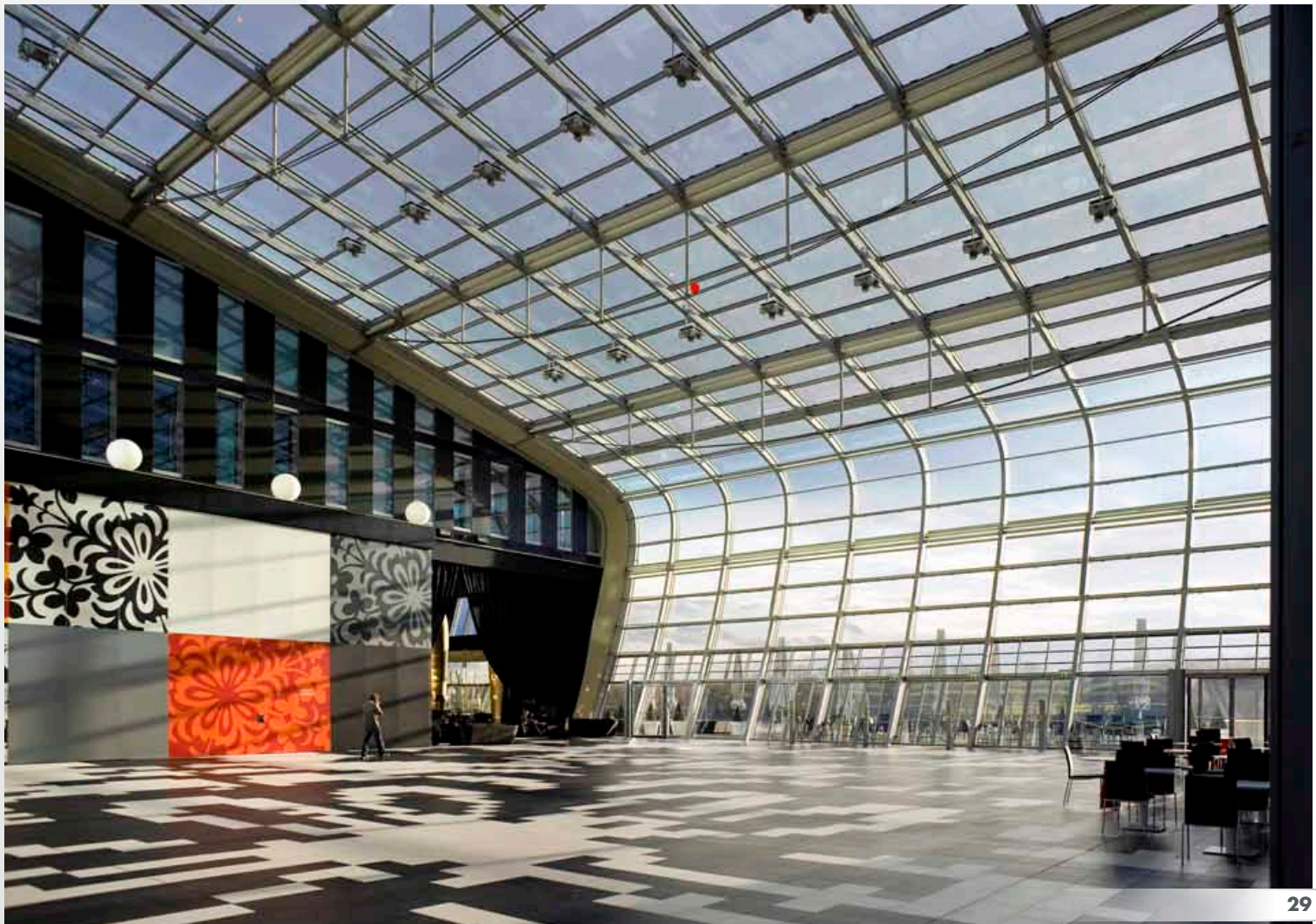



# Safety systems -fire and smoke protection

## Thermally insulated door and partition wall systems

RP-ISO-hermetic 70 FP EI 30-90

### RP-ISO-hermetic 70 FP EI 30 - Profile overview

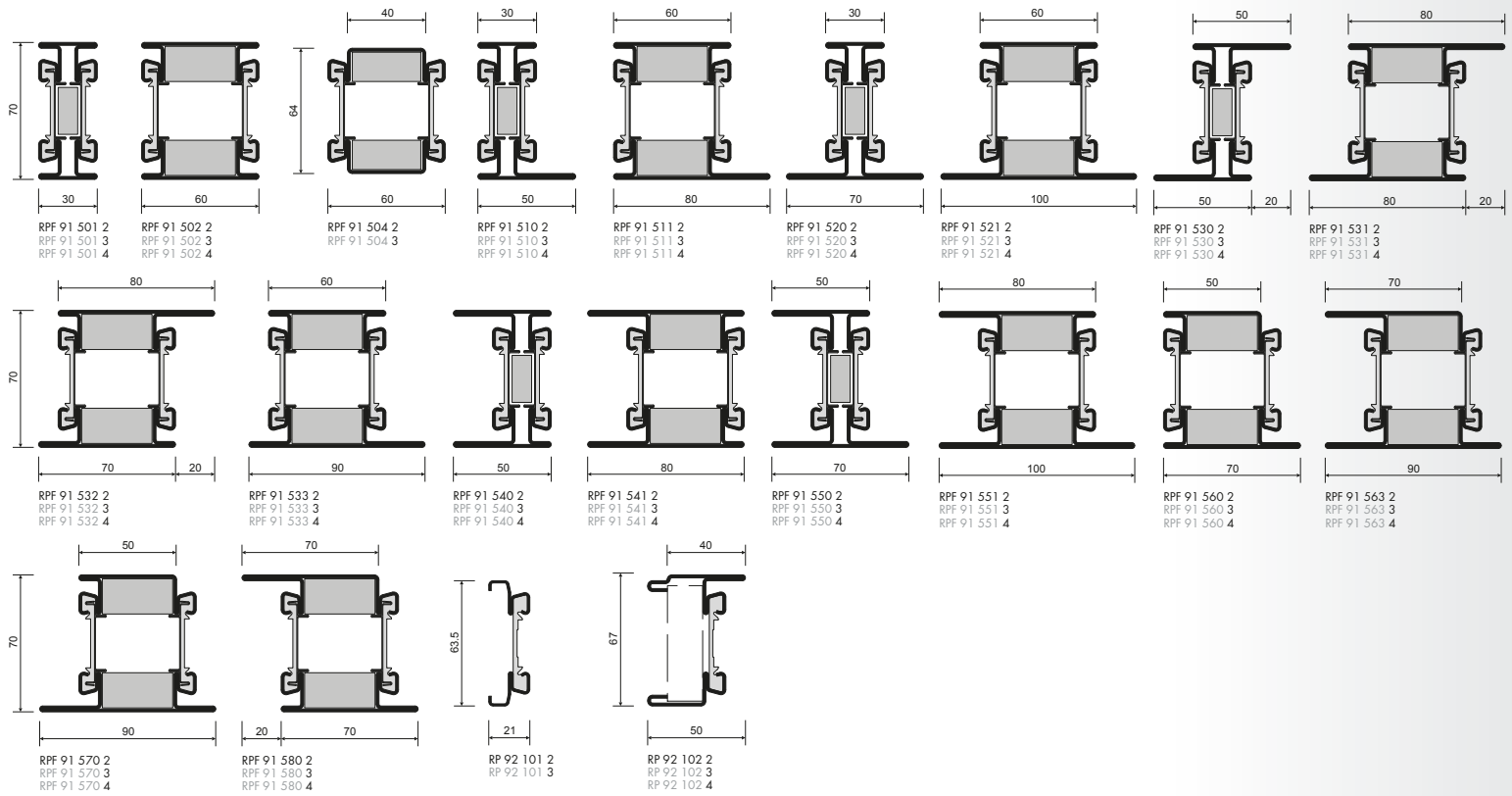

### RP-ISO-hermetic 70 FP EI 60 / EI 90 - Profile overview

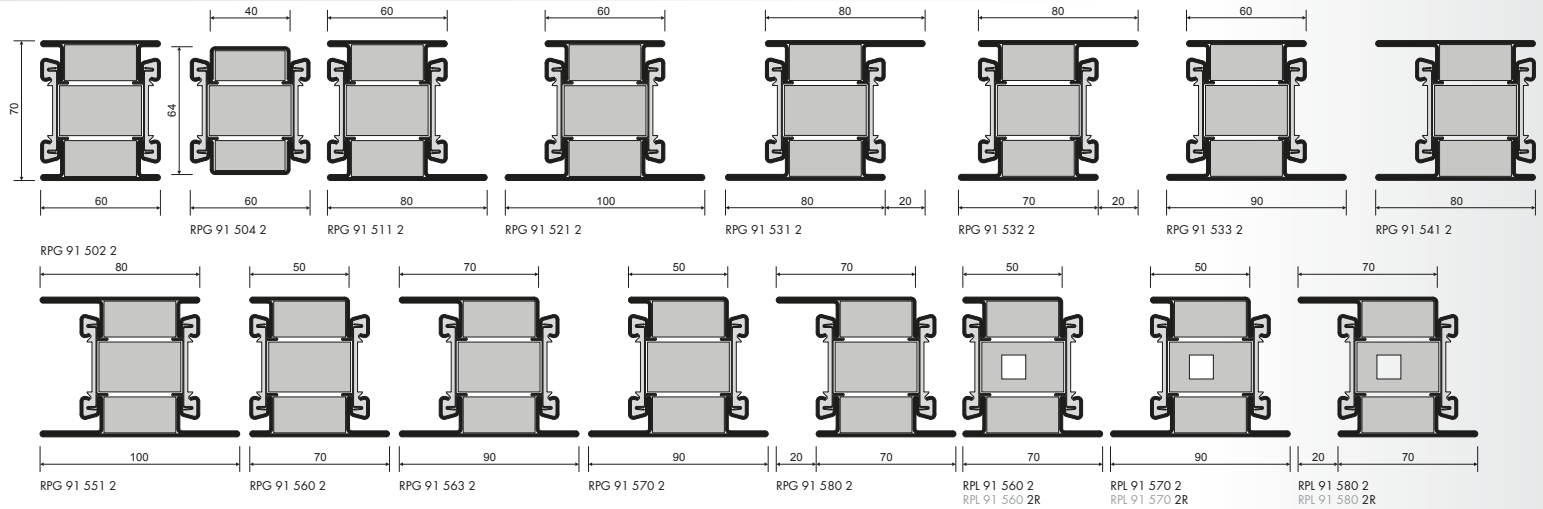

### Glazing beads

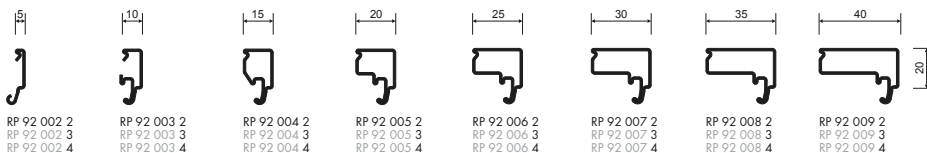

Note: Profiles are available with and without insulator

## RP-ISO-hermetic 70 FP EI 30-90 – System sections

### Doors RP-ISO-hermetic 70 FP EI 30

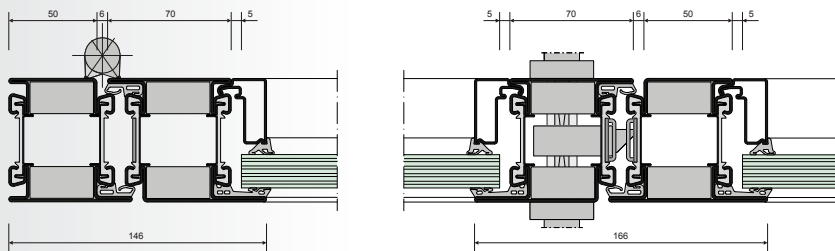

### Doors RP-ISO-hermetic 70 FP EI 60 / EI 90

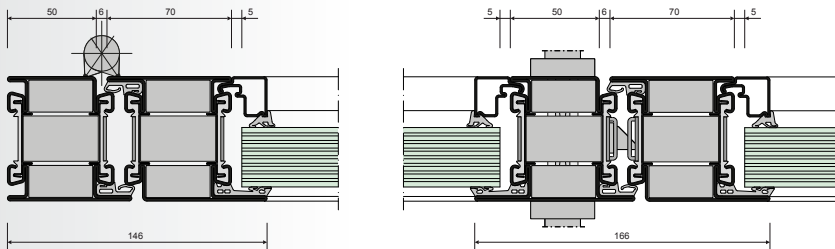

### Fixed glazing RP-ISO-hermetic 70 FP EI 60 / EI 90

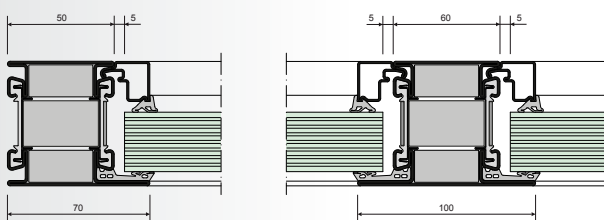

#### RP-ISO-hermetic 70 FP EI 30-90



—	Curtain walls
—	Add-on curtain wall system
●	Doors
●	Partition walls
—	Windows
—	Sliding elements

#### Evidence

When using the profile systems, the relevant national requirements, guidelines and building regulations must be observed while taking into account any available test evidence and recognition thereof.

### Advantages:

- Modular construction system → one profile for all classifications EI30, 60 and 90 by means of variable use of insulators
- Same elevation widths for doors and partition walls
- Prefabricated insulators for the lock area
- Use of unfilled profiles allows simple machining on a machining centre



### Thermally insulated door and partition wall system

RP-ISO-hermetic EI 120

#### RP-ISO-hermetic EI 120 – Profile overview

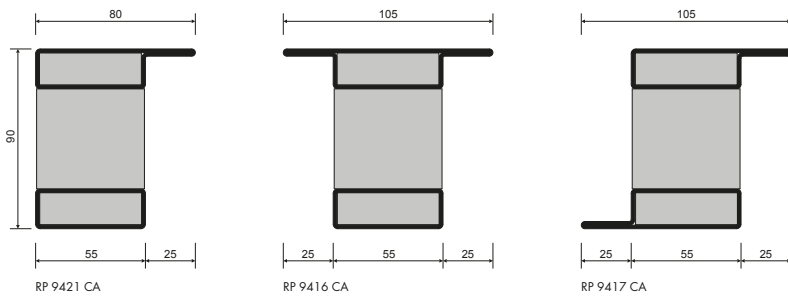



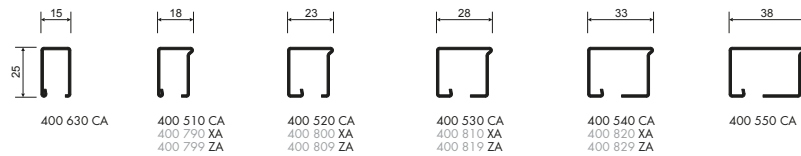

#### Glazing beads

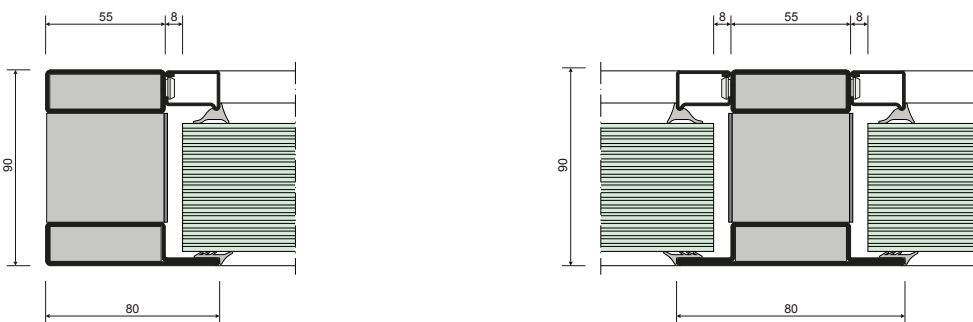

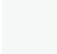
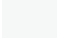
#### RP-ISO-hermetic EI 120 – System sections

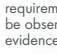

RP-ISO-hermetic EI120	
	Curtain walls
	Add-on curtain wall system
	Doors
	Partition walls
	Windows
	Sliding elements

#### Evidence

When using the profile systems, the relevant national requirements, guidelines and building regulations must be observed while taking into account any available test evidence and recognition thereof.

#### Advantages:

- EI-classified systems for fire protection for maximum safety over a period of 120 minutes
- Simple processing, especially when welding with closed half shells

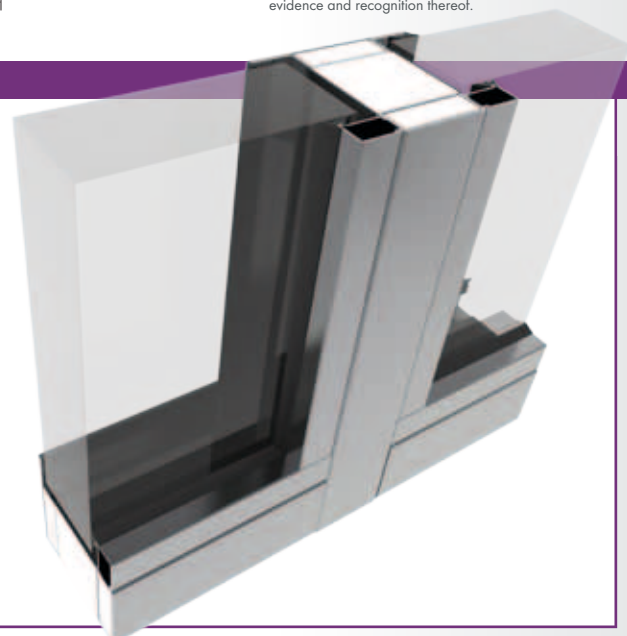



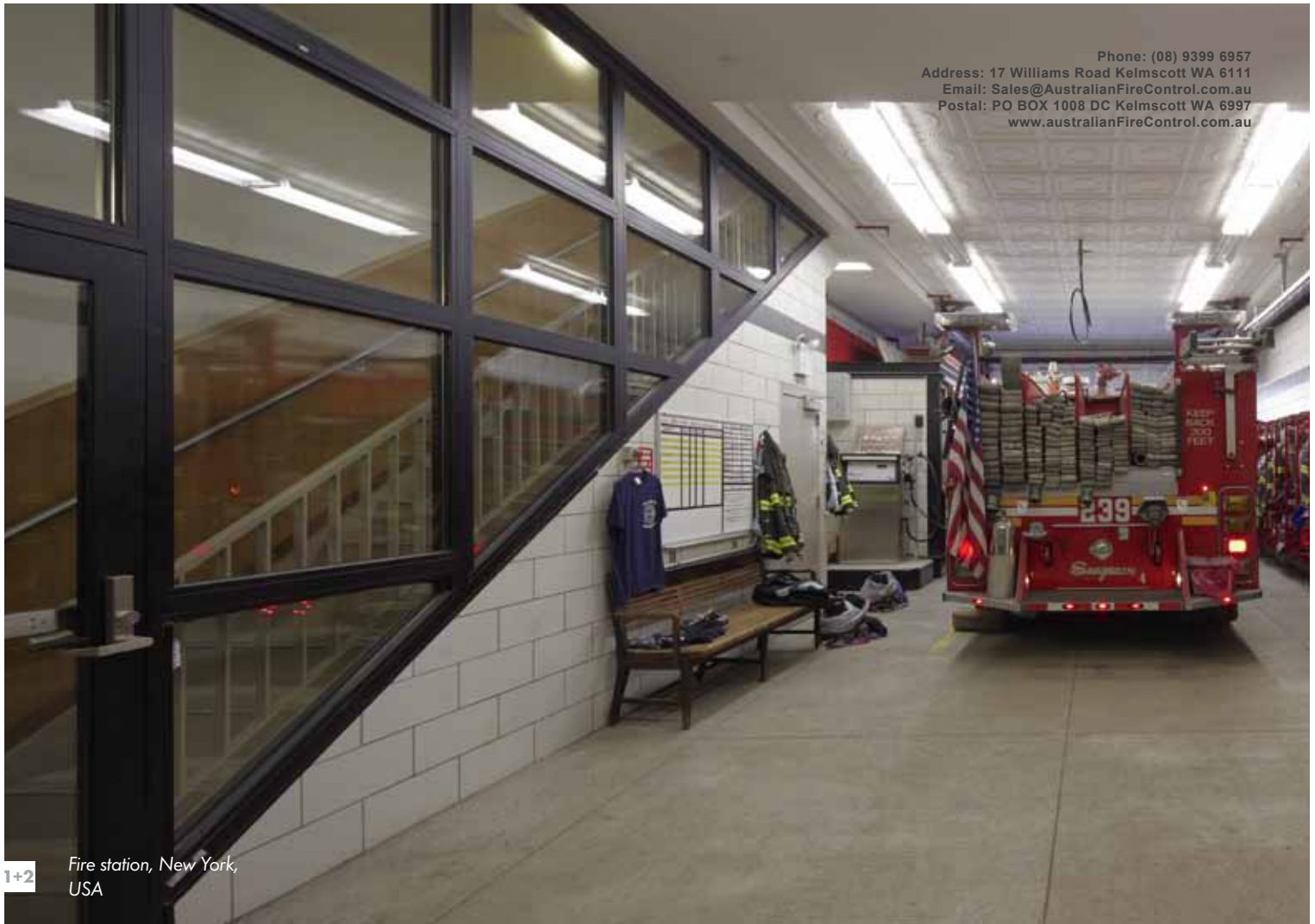

1+2

Fire station, New York,  
USA



# Safety systems -fire protection

## Curtain wall systems

RP-ISO-hermetic 45N / RP-ISO-hermetic 60N

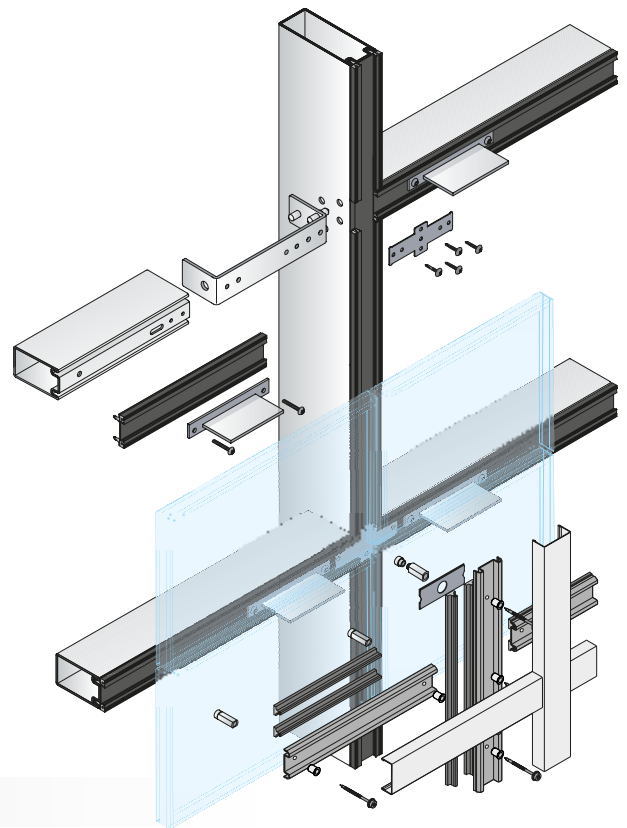

### RP-ISO-hermetic 45N EI 30-120 / E (W) 30 - Profile overview

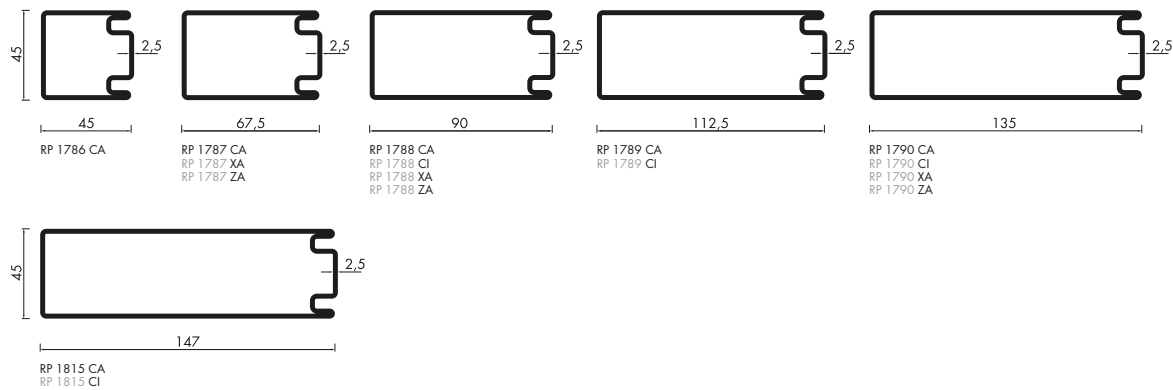

### Pressure profile / Cover profile

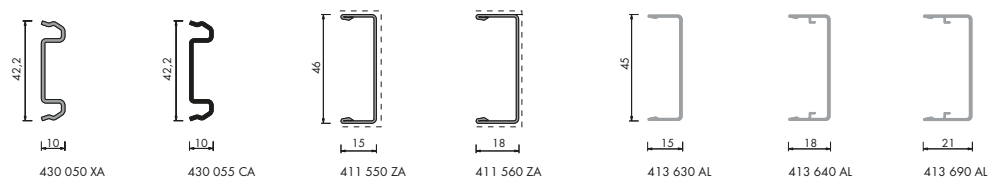

### RP-ISO-hermetic 45N

	● Curtain walls
	Add-on curtain wall system
	Doors
	Partition walls
	Windows
	Sliding elements

### Evidence

When using the profile systems, the relevant national requirements, guidelines and building regulations must be observed while taking into account any available test evidence and recognition thereof.

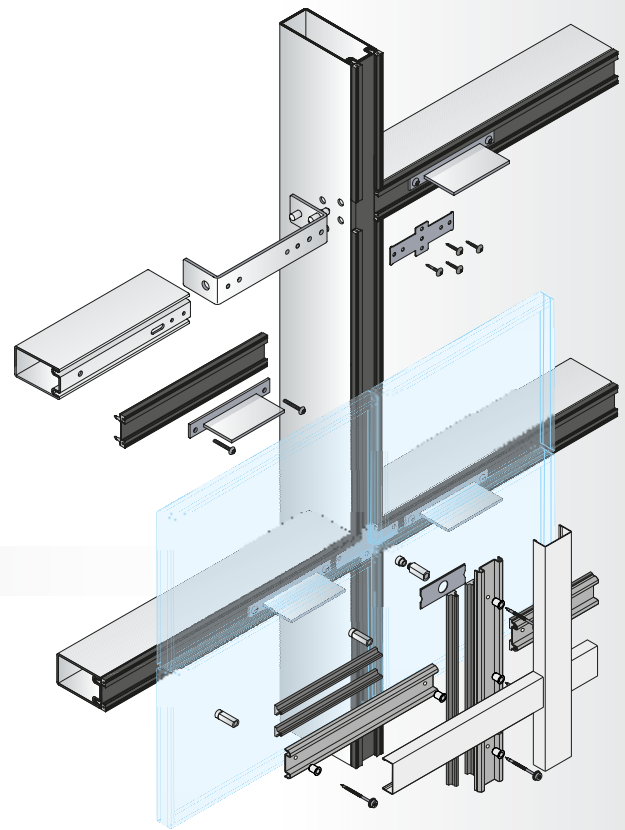

## RP-ISO-hermetic 60N EI 30-120 / E (W) 30 – Profile overview

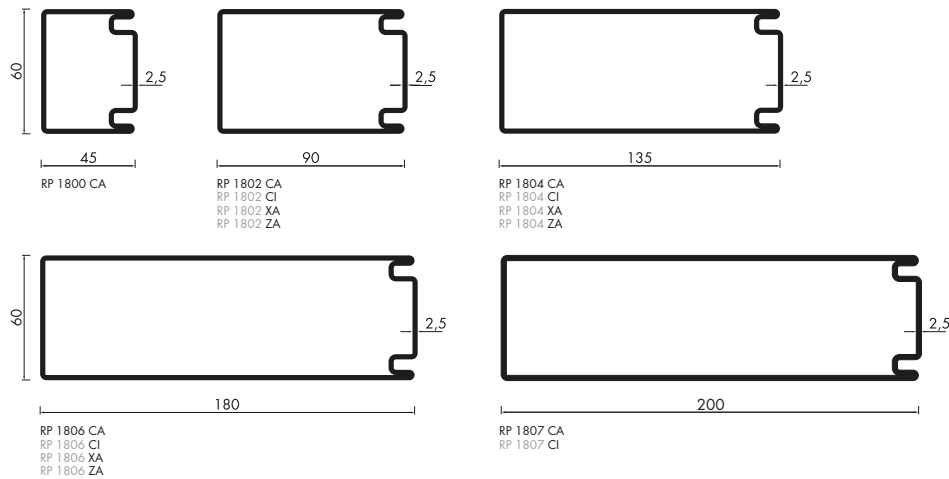

## Pressure profile / Cover profile

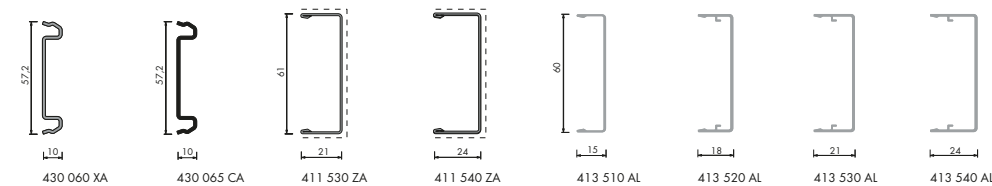

### RP-ISO-hermetic 60N

	● Curtain walls
	Add-on curtain wall system
	Doors
	Partition walls
	Windows
	Sliding elements

### Evidence

When using the profile systems, the relevant national requirements, guidelines and building regulations must be observed while taking into account any available test evidence and recognition thereof.

## Advantages:

- Three times the load-carrying capacity of aluminium, allowing large span widths/lengths
- Narrow elevation widths of 45 to 60 mm
- Innovative screw/plug connection for easier utilisation
- Vertical and polygonal versions possible
- RP-ISO-hermetic 45N/60N and RP-tec 55, a range of systems for all applications: thermal insulation, fire protection, general safety and security

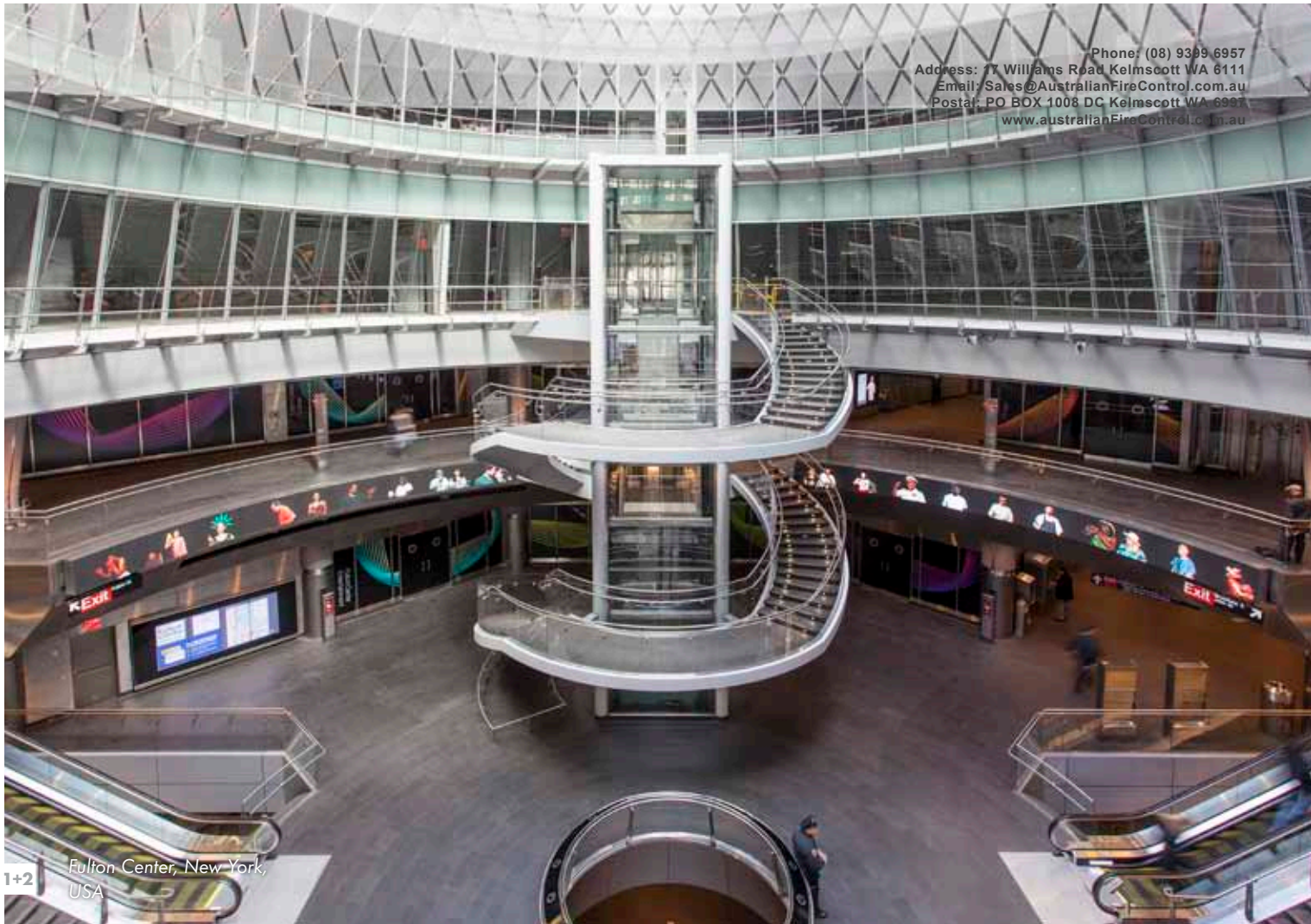

1+2 Fulton Center, New York, USA



## Safety systems -Bullet-resistance

### Door and partition wall systems

RP-hermetic 75 FB

#### RP-hermetic 75 - Profile overview

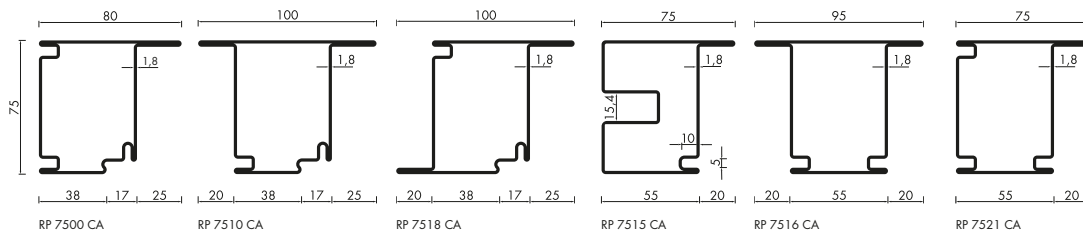

#### RP-hermetic 75 FB4 / FB6 - Profile overview

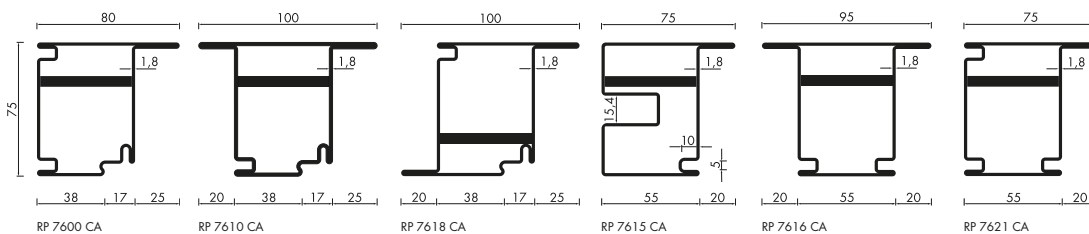

#### Glazing beads

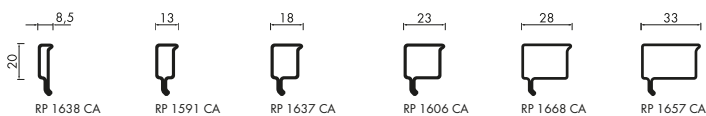

#### Advantages:

- One profile for a range of bullet resistance classes
- Simple processing
- 1,8 mm wall and 75 mm construction depth for high stability and performance capability
- Large infill thickness possible
- Profile are ready-made for FB4 with integrated flat steel
- Steel facing shell for simple extension of the protection objective from FB4 to FB6

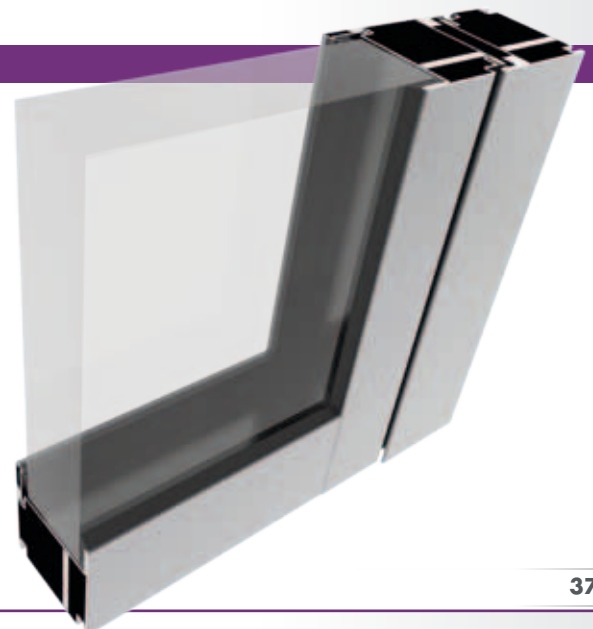

## RP-hermetic 75 FB4 - System sections

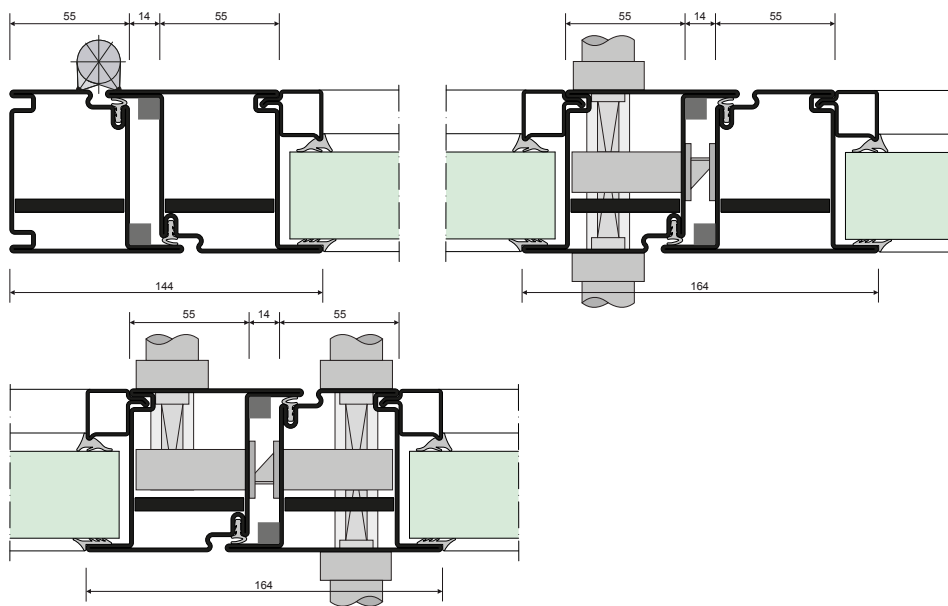

## RP-hermetic 75 FB6 - System sections

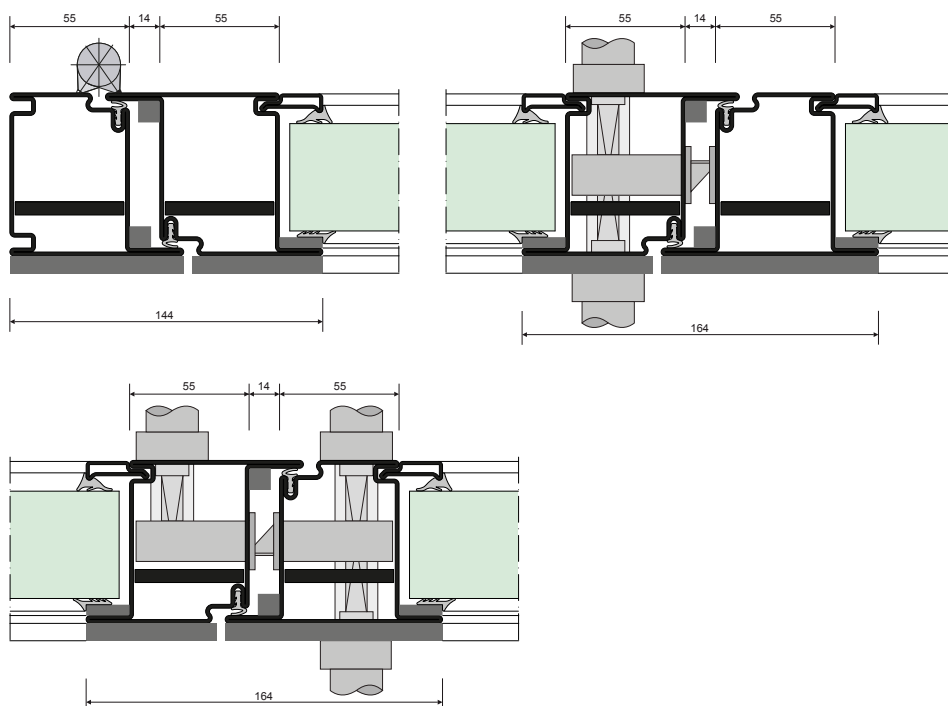

### RP-hermetic 75 FB4 / FB6



<input type="checkbox"/>	Curtain walls
<input type="checkbox"/>	Add-on curtain wall system
<input checked="" type="checkbox"/>	Doors
<input checked="" type="checkbox"/>	Partition walls
<input type="checkbox"/>	Windows
<input type="checkbox"/>	Sliding elements

### Evidence

When using the profile systems, the relevant national requirements, guidelines and building regulations must be observed while taking into account any available test evidence and recognition thereof.

# Safety systems -Bullet-resistance







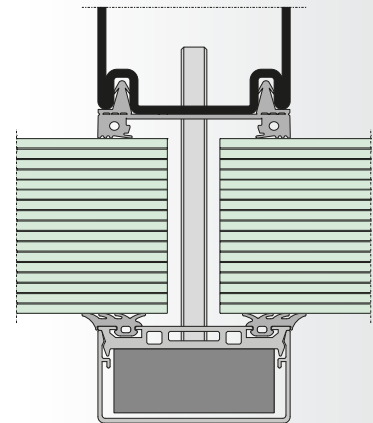
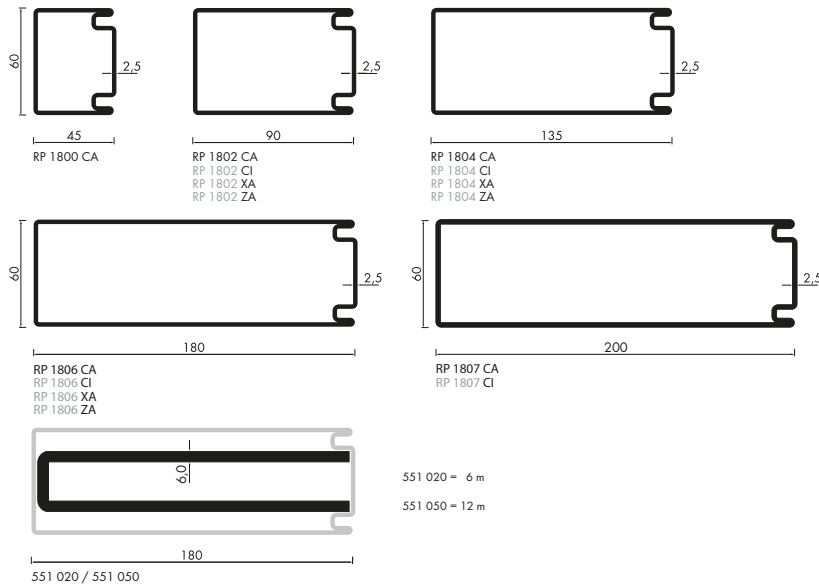





## Curtain wall systems

RP-ISO-hermetic 60N FB7

### RP-ISO-hermetic 60N FB7 – Profile overview

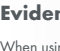
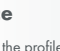
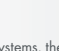
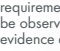
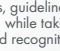
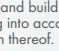

RP-ISO-hermetic 60N FB7

			<input checked="" type="checkbox"/> Curtain walls
			<input type="checkbox"/> Add-on curtain wall system
			<input type="checkbox"/> Doors
			<input type="checkbox"/> Partition walls
			<input type="checkbox"/> Windows
			<input type="checkbox"/> Sliding elements

#### Evidence

When using the profile systems, the relevant national requirements, guidelines and building regulations must be observed while taking into account any available test evidence and recognition thereof.

### Pressure profile / Cover profile

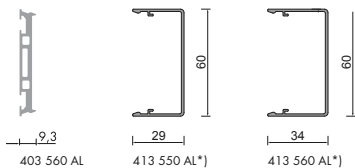

### Advantages:

- Multifunctional system – the highest possible classifications can be reached without major changes – fire protection (EI 120) or bullet-resistance (FB 7)
- Three times the load-carrying capacity of aluminium, allowing large span widths/lengths
- Narrow elevation widths of 45 to 60 mm
- Innovative screw/plug connection for easier utilisation
- Vertical and polygonal versions possible
- RP-ISO-hermetic 45N / 60N and RP-tec 55, a range of systems for all applications: thermal insulation, fire protection, general safety and security



the steel line - RP standard profiles  
since 1954 - the original

Phone: (08) 9399 6957  
Address: 17 Williams Road Kelmscott WA 6111  
Email: Sales@AustralianFireControl.com.au  
Postal: PO BOX 1008 DC Kelmscott WA 6997  
www.australianFireControl.com.au

### LINE 34

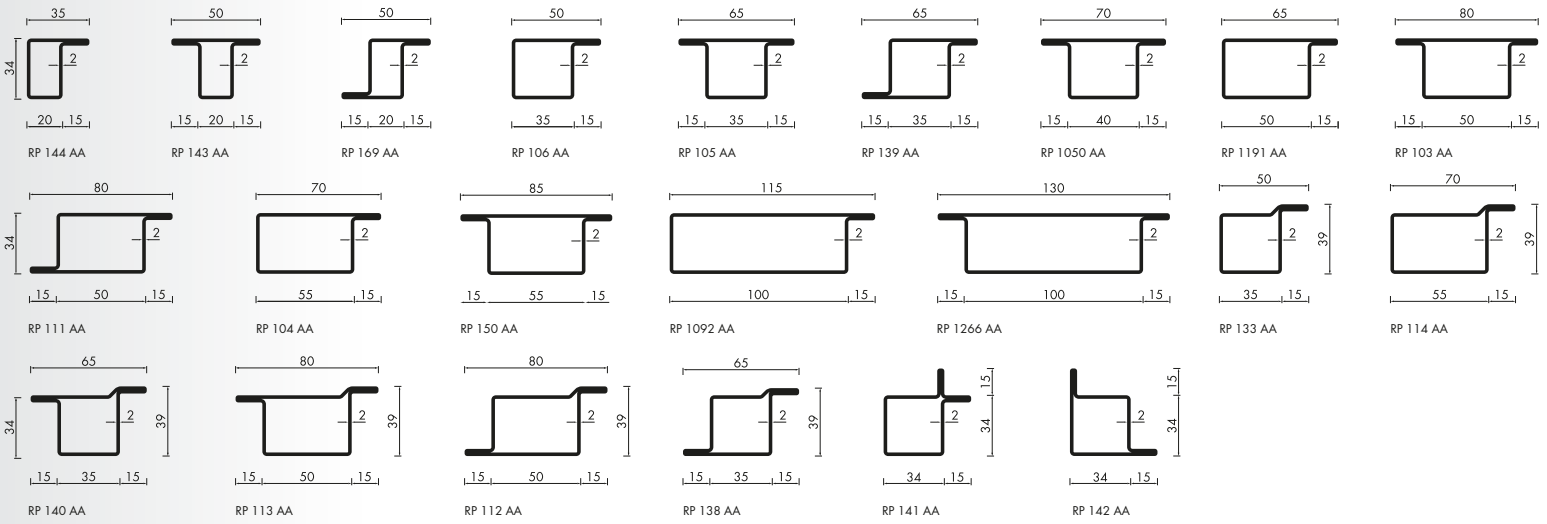

### LINE 40

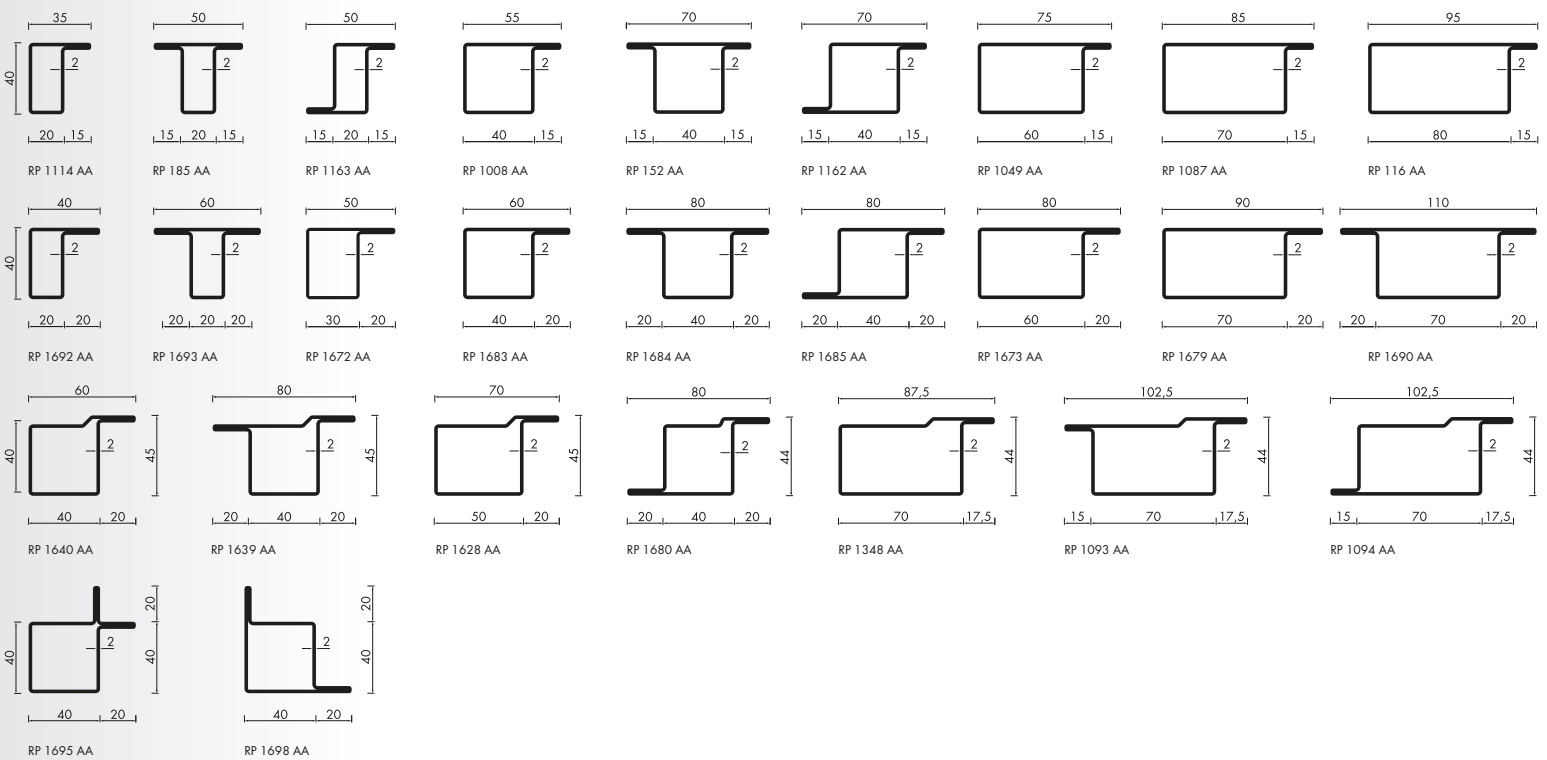

### LINE 50

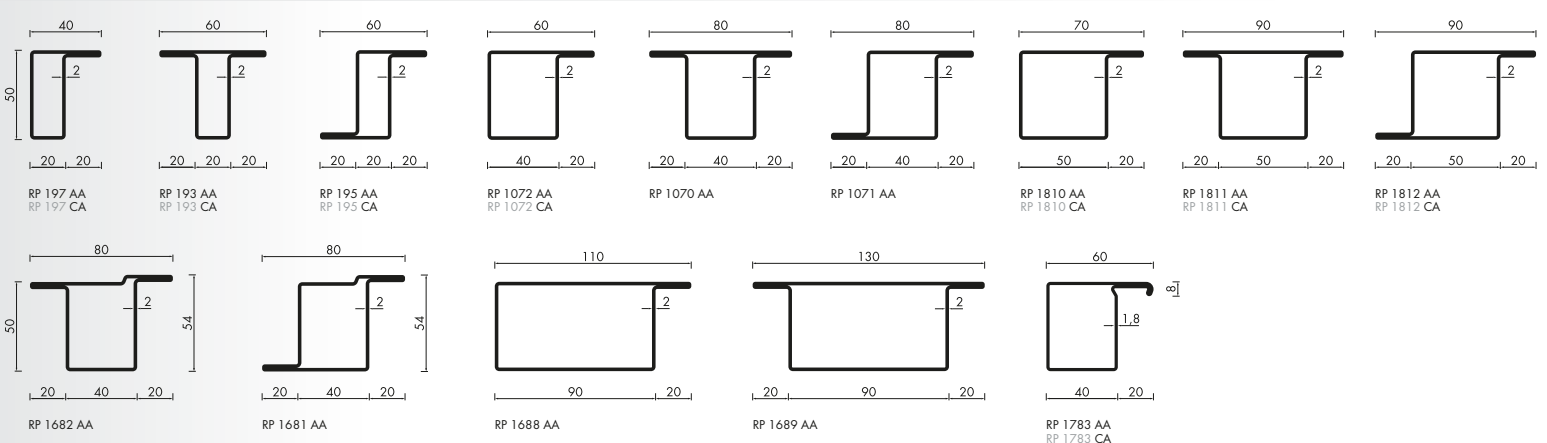



## RP Design 50

Phone: (08) 9399 6957  
 Address: 17 Williams Road Kelmscott WA 6111  
 Email: Sales@AustralianFireControl.com.au  
 Postal: PO BOX 1008 DC Kelmscott WA 6997  
 www.australianFireControl.com.au

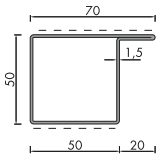

RP 1833 AA  
 RP 1833 CA  
 RP 1833 XA  
 RP 1833 ZA

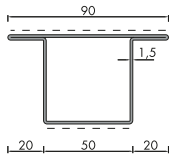

RP 1834 AA  
 RP 1834 CA  
 RP 1834 XA  
 RP 1834 ZA

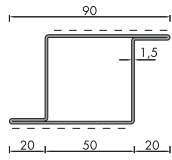

RP 1835 CA  
 RP 1835 XA  
 RP 1835 ZA

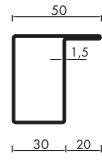

RP 1867 CA



RP 1868 CA

## LINE 60

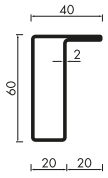

RP 1647 AA  
 RP 1647 CA

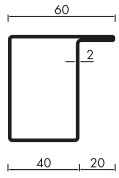

RP 1592 AA  
 RP 1592 CA

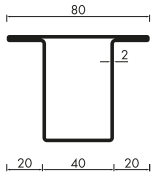

RP 1596 AA  
 RP 1596 CA

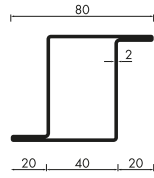

RP 1594 AA

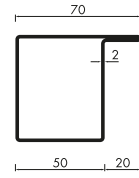

RP 1645 AA

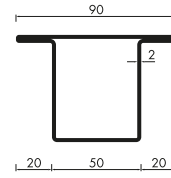

RP 1646 AA

## LINE 80

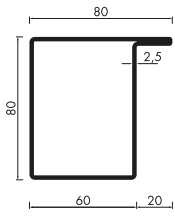

RP 1593 AA

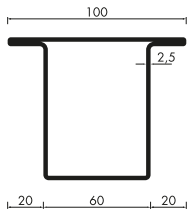

RP 1597 AA

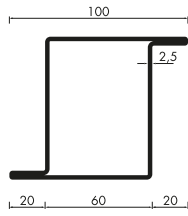

RP 1595 AA

## LINE S

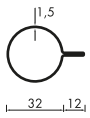

RP 202 AA

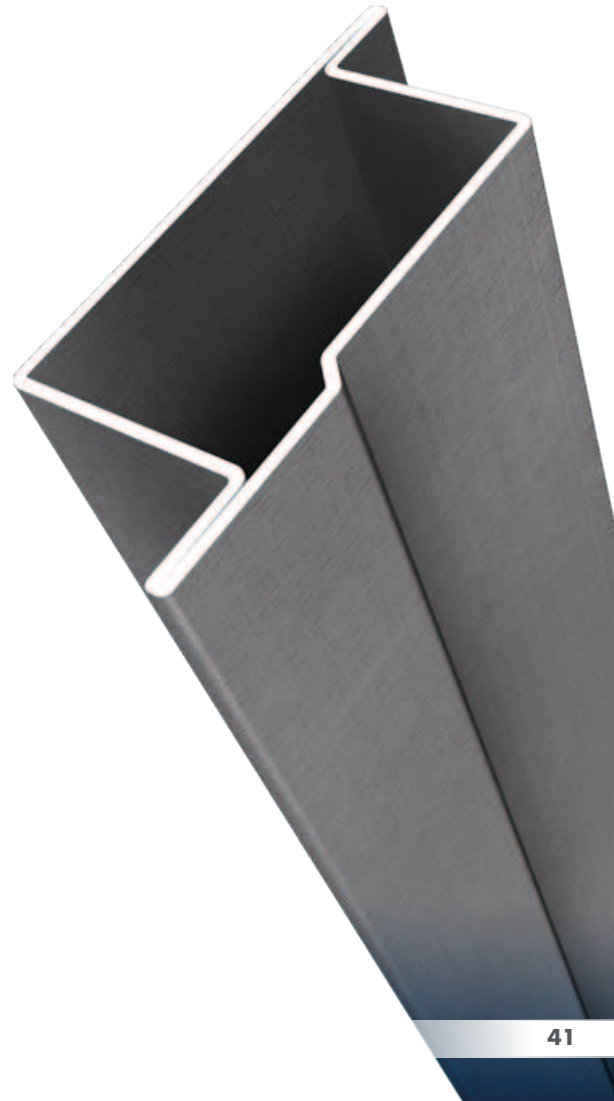



# High-quality service & dedicated support

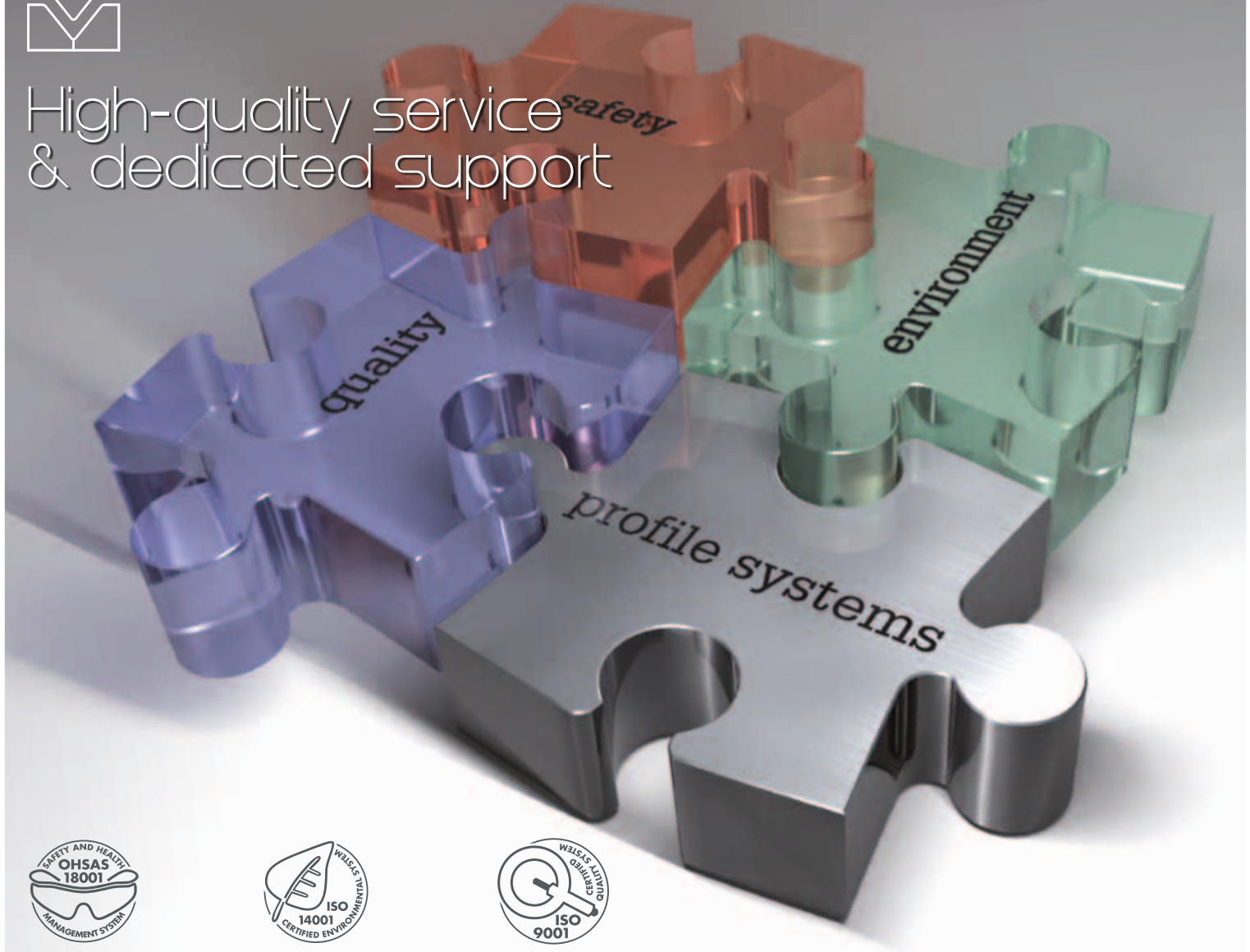

## Health

Occupational safety and the protection of health are the mainstay of any successful enterprise. Our long-standing corporate principles reach far beyond the confines of accident prevention. Health and well-being are an unwavering concern of our company.

## Environmental protection

We are responsible for the environment we inhabit. A stable environment is key to our success as a company, both now and in future. Environmental protection, when practised on a daily basis, is a prerequisite for building our common future. For this to happen, all employees need to pull together in one direction.

## Quality

Seamless quality control at all stages of the production process are a sure-fire guarantee of RP Technik's commitment to unimpeachable quality when it comes to delivering impeccable high-grade profile systems.

Please visit our homepage:  
**[www.rp-technik.com](http://www.rp-technik.com)**

In our Download-Center all our technical documentations and brochures are available for download.



## A LONG-STANDING AND SUCCESSFUL PARTNERSHIP

Close partnership with customers, translated into practical, day-to-day cooperation is a solid foundation for success. RP Technik is your unswerving partner for the development of steel profiles. From architects to planners, our customers benefit from a plethora of skills offered by a group of specialists working for a company which is both an expert in its field and active on the world stage. Insider knowledge of the industry and the full panoply of experience garnered from years of developing steel profiles mean partners of RP Technik have a clear advantage on the world markets, our unrelenting focus being on personal safety and building protection.



Profile systems	Curtain walls	Add-on curtain wall system	Doors	Partition walls	Windows	Sliding elements	Evidence	National requirements, directives and building regulations specific to the various Federal States must be observed while taking into account evidence garnered from tests and any approvals related thereto.
RP-ISO-hermetic 45N	●							
RP-ISO-hermetic 60N	●							
RP-tec 55	●							
RP-tec 50-1		●						
RP-tec 55-1		●						
RP-tec 50-1 HA		●						
RP-tec 55-1 HA		●						
RP-tec 50-1 HA plus		●						
RP-tec 55-1 HA plus		●						
RP-tec 60-1		●						
RP-tec 60-1 HA		●						
RP-tec 80-1		●						
RP-tec 80-1 HA		●						
RP-ISO-hermetic 70			●	●				
RP-ISO-hermetic 70					●			
RP-ISO-hermetic 70 plus			●	●				
RP-ISO-hermetic 70 plus					●			
RP-ISO-FINELINE				●	●			
RP-hermetic FINELINE				●	●	●		
RP-hermetic 40			●	●				
RP-hermetic 55N				●	●			
RP-hermetic 55N					●			
RP-hermetic 55N FP				●	●			
RP-hermetic 75				●	●			
RP-hermetic 75 FB				●	●			
RP-ISO-hermetic EI120				●				
RP-ISO-hermetic 70 FP				●	●			

**rp**  
**technik**  
profile systems



### Fold-out caption of article numbers

- AA = steel S235 JR bright rolled, 6.000 mm
- CI = steel continuously hot dip coated, 7.500 mm
- CA = steel continuously hot dip coated, 6.000 mm
- CR = steel continuously hot dip coated, 3.000 mm
- XA = stainless steel 1.4301 (304), surface raw material 2B, 6.000 mm
- XR = stainless steel 1.4301 (304), surface raw material 2B, 3.000 mm
- ZA = stainless steel 1.4301 (304), outer surface ground, size 220-240, foiled, 6.000 mm
- ZR = stainless steel 1.4301 (304), outer surface ground, size 220-240, foiled, 3.000 mm

### Optional surface treatment for AA

- BA = galvanized (Unit galvanizing), DIN EN ISO 1461, on both sides minimum 70 µm, 6.000 mm
- DA = zinc-plated (blue/yellow chromed), DIN 50961, outer layer minimum 8 µm, 6.000 mm
- AL = aluminium EN AW 6060, state T66, 6.000 mm
- ▲ = Chloroprene
- ° = self-adhesive

- End digit 0 = steel S235JR, bright rolled, 6.000 mm
- End digit 1 = aluminium EN AW 6060, state T66, 6.000 mm
- End digit 2 = steel S280GD continuously hot-dip coated, 6.000 mm
- End digit 3 = stainless steel, 1.4401 (316), surface raw material 2B, 6.000 mm
- End digit 4 = stainless steel, 1.4401 (316), outer surfaces ground, size 400, foiled, 6.000 mm
- End digit 5 = aluminium black, 6.000 mm

- R = Delivery length 3.000 mm
- \*) Price and Delivery on demand
- Q = Delivery length 7.000 mm

When putting together applications, the respective national requirements, guidelines and building regulations of the country concerned must be observed with consideration of the available test certificates and their approval.



# www.rp-technik.com



**Welser Profile Deutschland GmbH**  
Edisonstraße 23  
59199 Bönen / DEUTSCHLAND  
Tel (+49 2383) 914-0  
Fax (+49 2383) 914-5555  
de@welser.com

**Welser Profile Austria GmbH**  
3341 Ybbsitz / ÖSTERREICH  
Tel (+43 7443) 800-0  
Fax (+43 7443) 800-4111  
ai@welser.com

3264 Gresten / ÖSTERREICH  
Tel (+43 7487) 410-0  
Fax (+43 7487) 410-4111

**RP Technik GmbH Profilsysteme**  
Edisonstraße 4  
59199 Bönen / DEUTSCHLAND  
Tel (+49 2383) 91 49-0  
Fax (+49 2383) 91 49-222  
info@rp-technik.com

Ferdinand-Braun-Straße 26  
74074 Heilbronn / DEUTSCHLAND

Your sales partner for RP Technik's profile systems  
and standard profiles:



**Phone: (08) 9399 6957**  
**Address: 17 Williams Road Kelmscott WA 6111** **Email:**  
**Sales@AustralianFireControl.com.au \**  
**Postal: PO BOX 1008 DC Kelmscott WA 6997**  
**www.australianFireControl.com.au**



**Imprint**  
© RP Technik GmbH Profilsysteme  
Layout and Outwork: arche-nova.at  
Printed by Druckerei Dassel Druck • 2<sup>nd</sup> edition-EN-08.2016  
Änderungen und Irrtümer vorbehalten.  
Modifications and errors reserved.  
Sous réserve de modifications et d'erreurs.  
Art.-Nr. 1160001

www.rp-technik.com