

DOOR TYPE: AFC-03

Entry level metal faced door with visible capping to head only.

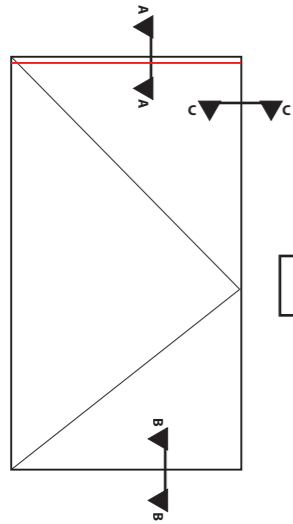

ELEVATION

Entry Level | SCALE: NTS

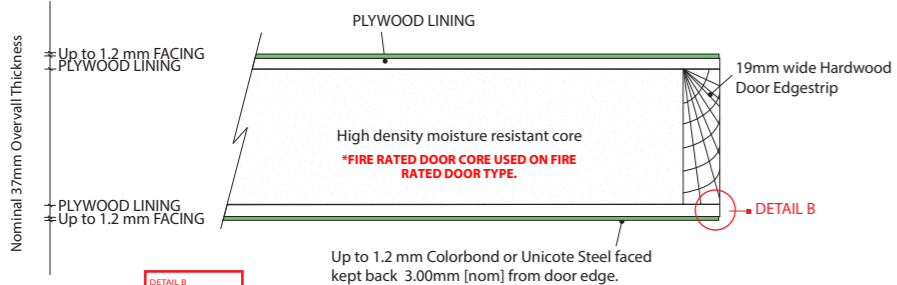

SECTION CC

Through side edge of door | SCALE: NTS

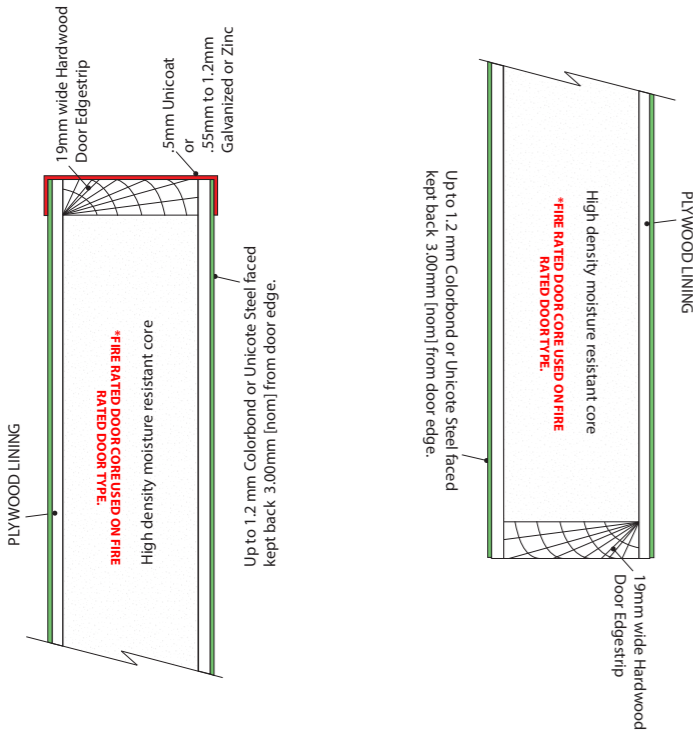

SECTION AA

Head of Door | SCALE: NTS

SECTION BB

Underside Door | SCALE: NTS

DOOR TYPE: AFC-02

Medium level metal faced with visible capping all round

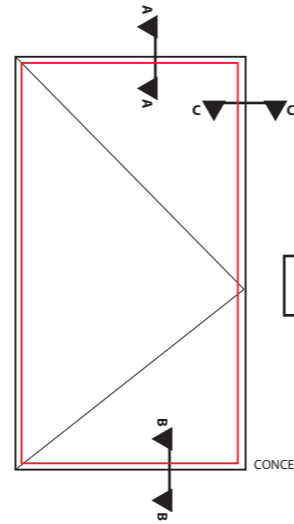

ELEVATION

Medium Level Door | SCALE: NTS

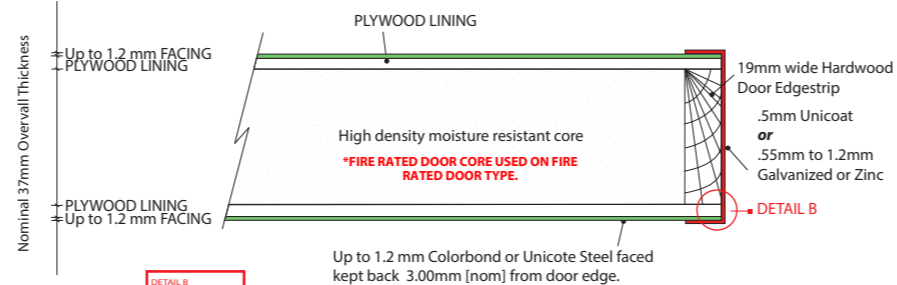

SECTION CC

Through side edge of door | SCALE: NTS

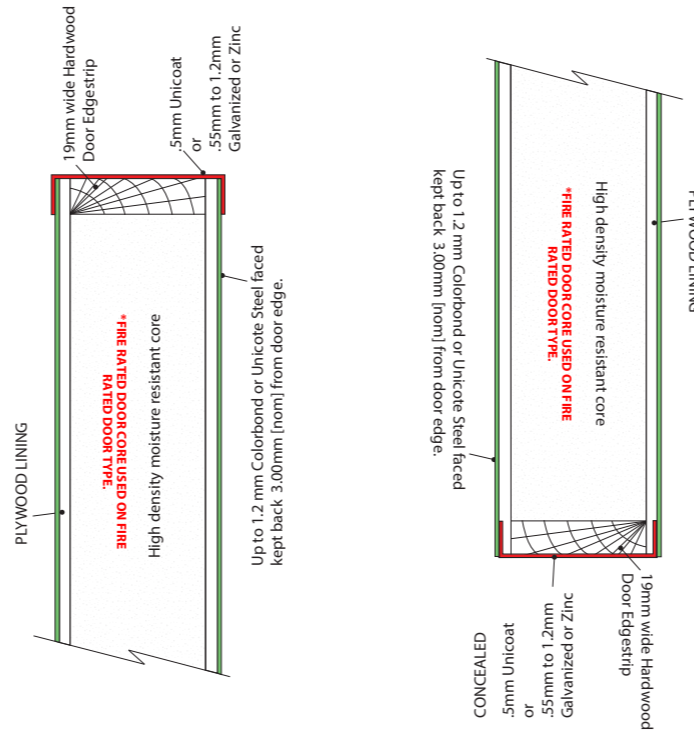

SECTION AA

Head of Door | SCALE: NTS

SECTION BB

Underside Door | SCALE: NTS

DOOR TYPE: AFC-01

Proprietary "Defender Steel Guard" metal enveloped with concealed capping. Class 1-3 manual attack resistance as per EN1627

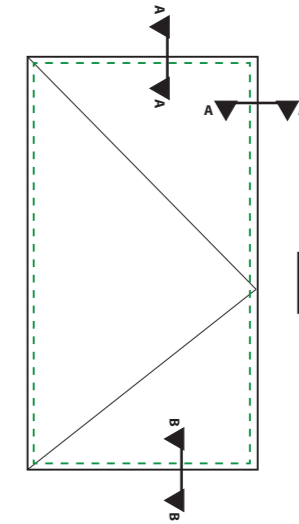

ELEVATION

Defender Steel Guard Door | SCALE: NTS

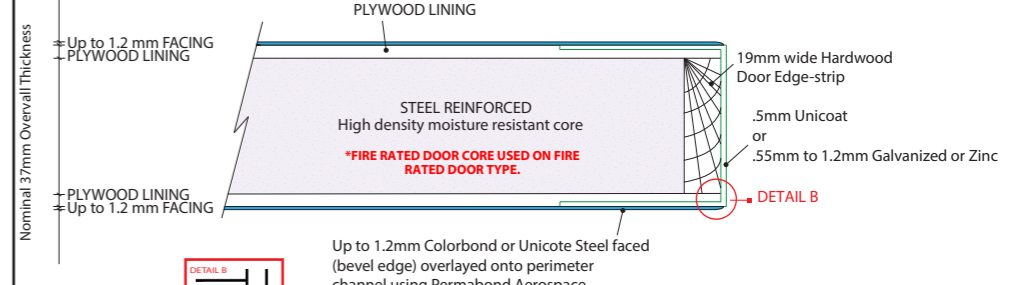

SECTION AA

Through side & head of door | SCALE: NTS

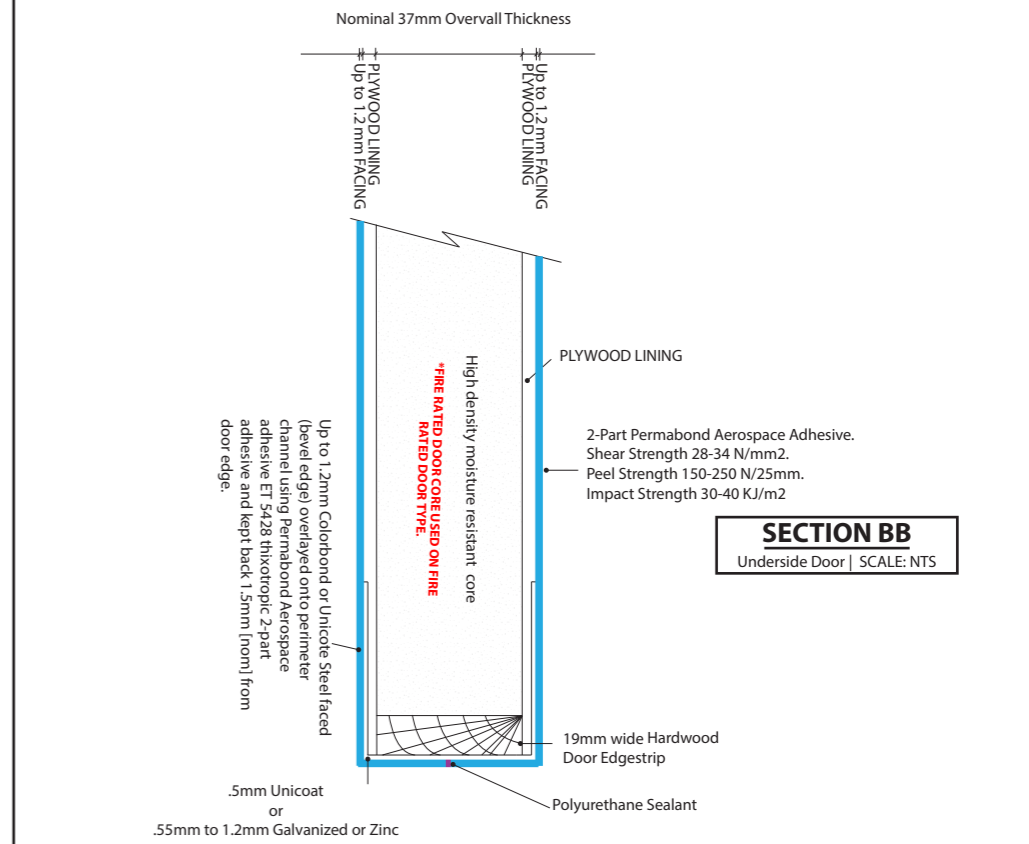

SECTION BB

Underside Door | SCALE: NTS



ABN: 27 597 781 081
ACN: 145 672 859
COMPANY NAME: Australian Fire Control Pty Ltd as Trustee for the Robb Family Trust as Australian Fire Control

Phone: (08) 9399 6957

Address: 17 Williams Road Kelmscott WA 6111

Email: Sales@AustralianFireControl.com.au

Web: www.AustralianFireControl.com.au

Fire & Non-Fire Rated Doorsets Timber Metal Clad Door Types

COMMERCIAL - IN - CONFIDENCE

Drawn by: Michael Robb
Date: 20.06.2022
Drawing Ref: SGD5847-8975
Page: 1 of 2
Scale: NTS

PROJECT:

ATTENTION: